

# FLOOR PLANS

TOWER 1

CREEK GATE

# DUBAI CREEK

## HARBOUR

### CREEK GATE



## 1 BEDROOM WITH BALCONY

TOWER 1  
UNIT 1 | LEVELS 3-17, 19-30

Suite Area 645 Sq.ft. / 59.90 Sq.m.  
Balcony Area 80 Sq.ft. / 7.42 Sq.m.  
Total Area 725 Sq.ft. / 67.32 Sq.m.

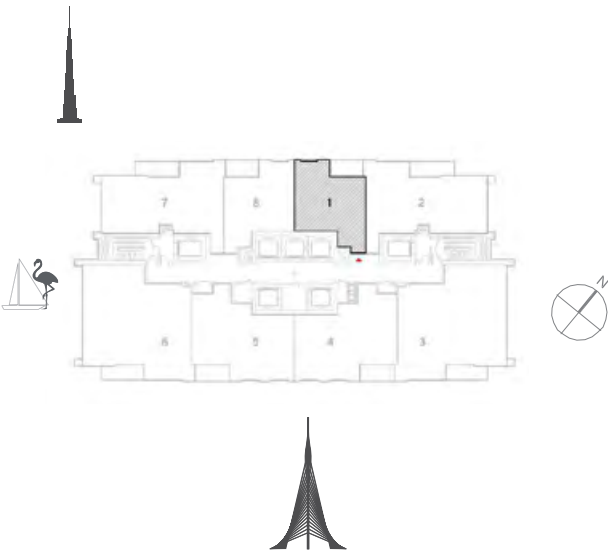

1. All dimensions are in imperial and metric, and measured to structural elements and exclude wall finishes and construction tolerances. 2. All materials, dimensions, and drawings are approximate only. 3. Information is subject to change without notice, at developer's absolute discretion. 4. Actual area may vary from the stated area. 5. Drawings not to scale. 6. All images used are for illustrative purposes only and do not represent the actual size, features, specifications, fittings, and furnishings. 7. The developer reserves the right to make revisions/ alterations, at its absolute discretion, without any liability whatsoever. \*Please note that landscaping and swimming pool are not provided by the developer.

# DUBAI CREEK

## HARBOUR

### CREEK GATE



## 2 BEDROOM WITH BALCONY

TOWER 1  
UNIT 2 | LEVELS 3-17, 19-30

Suite Area 1018 Sq.ft. / 94.58 Sq.m.

Balcony Area 93 Sq.ft. / 8.60 Sq.m.

Total Area 1111 Sq.ft. / 103.18 Sq.m.

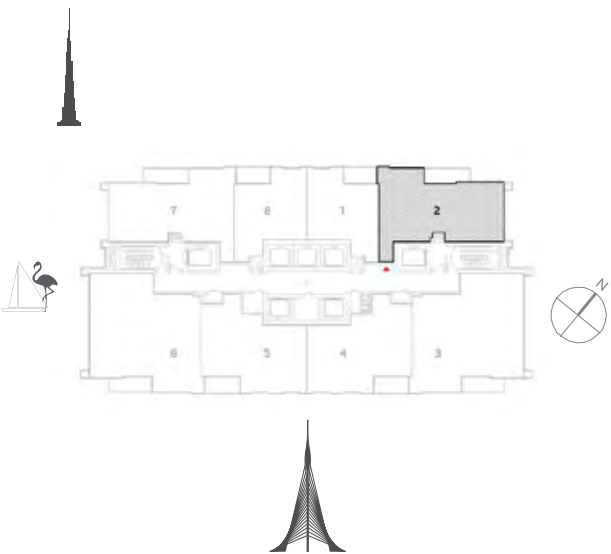

1. All dimensions are in imperial and metric, and measured to structural elements and exclude wall finishes and construction tolerances. 2. All materials, dimensions, and drawings are approximate only. 3. Information is subject to change without notice, at developer's absolute discretion. 4. Actual area may vary from the stated area. 5. Drawings not to scale. 6. All images used are for illustrative purposes only and do not represent the actual size, features, specifications, fittings, and furnishings. 7. The developer reserves the right to make revisions/ alterations, at its absolute discretion, without any liability whatsoever. \*Please note that landscaping and swimming pool are not provided by the developer.

# DUBAI CREEK

## HARBOUR

### CREEK GATE



### 3 BEDROOM WITH BALCONY

TOWER 1  
UNIT 3 | LEVELS 3-17, 19-30

Suite Area	1403 Sq.ft. / 130.31 Sq.m.
Balcony Area	87 Sq.ft. / 8.11 Sq.m.
Total Area	1490 Sq.ft. / 138.42 Sq.m.

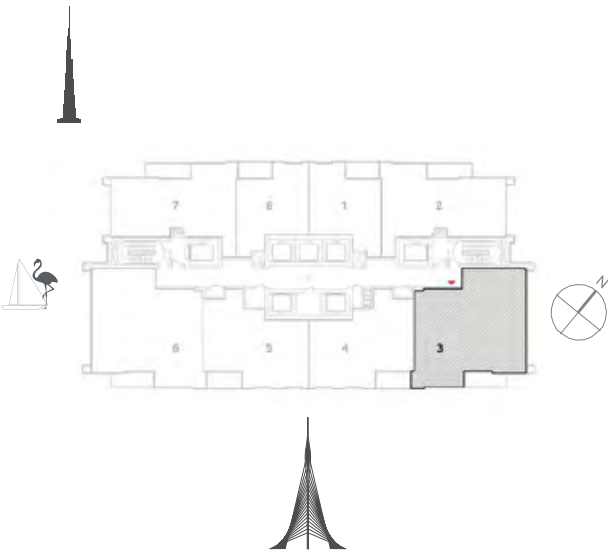

1. All dimensions are in imperial and metric, and measured to structural elements and exclude wall finishes and construction tolerances. 2. All materials, dimensions, and drawings are approximate only. 3. Information is subject to change without notice, at developer's absolute discretion. 4. Actual area may vary from the stated area. 5. Drawings not to scale. 6. All images used are for illustrative purposes only and do not represent the actual size, features, specifications, fittings, and furnishings. 7. The developer reserves the right to make revisions/ alterations, at its absolute discretion, without any liability whatsoever. \*Please note that landscaping and swimming pool are not provided by the developer.

# DUBAI CREEK

## HARBOUR

### CREEK GATE



## 2 BEDROOM WITH BALCONY

TOWER 1  
UNIT 4 | LEVELS 3-17, 19-30

Suite Area 963 Sq.ft. / 89.47 Sq.m.

Balcony Area 83 Sq.ft. / 7.68 Sq.m.

Total Area 1046 Sq.ft. / 97.15 Sq.m.

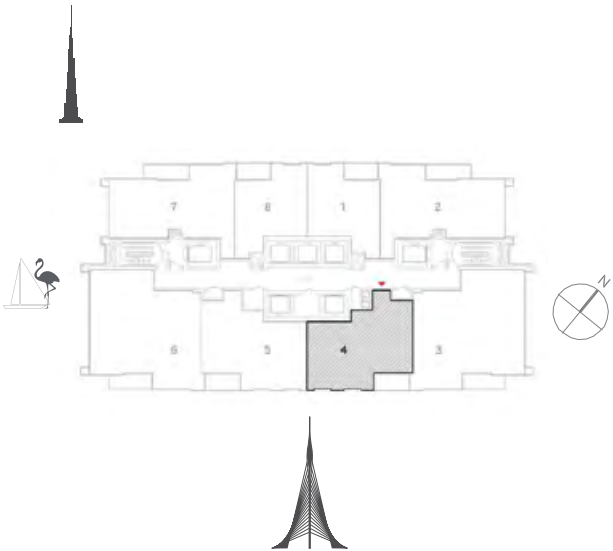

1. All dimensions are in imperial and metric, and measured to structural elements and exclude wall finishes and construction tolerances. 2. All materials, dimensions, and drawings are approximate only. 3. Information is subject to change without notice, at developer's absolute discretion. 4. Actual area may vary from the stated area. 5. Drawings not to scale. 6. All images used are for illustrative purposes only and do not represent the actual size, features, specifications, fittings, and furnishings. 7. The developer reserves the right to make revisions/ alterations, at its absolute discretion, without any liability whatsoever. \*Please note that landscaping and swimming pool are not provided by the developer.

# DUBAI CREEK

## HARBOUR

### CREEK GATE



## 2 BEDROOM WITH BALCONY

TOWER 1  
UNIT 5 | LEVELS 3-17, 19-30

Suite Area 963 Sq.ft. / 89.47 Sq.m.

Balcony Area 83 Sq.ft. / 7.68 Sq.m.

Total Area 1046 Sq.ft. / 97.15 Sq.m.

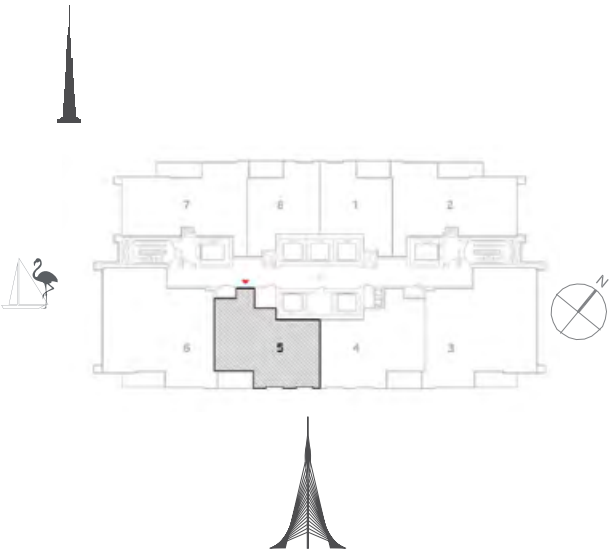

1. All dimensions are in imperial and metric, and measured to structural elements and exclude wall finishes and construction tolerances. 2. All materials, dimensions, and drawings are approximate only. 3. Information is subject to change without notice, at developer's absolute discretion. 4. Actual area may vary from the stated area. 5. Drawings not to scale. 6. All images used are for illustrative purposes only and do not represent the actual size, features, specifications, fittings, and furnishings. 7. The developer reserves the right to make revisions/ alterations, at its absolute discretion, without any liability whatsoever. \*Please note that landscaping and swimming pool are not provided by the developer.

# DUBAI CREEK

## HARBOUR

### CREEK GATE



## 3 BEDROOM WITH BALCONY

TOWER 1  
UNIT 6 | LEVELS 3-17, 19-30

Suite Area 1403 Sq.ft. / 130.31 Sq.m.

Balcony Area 87 Sq.ft. / 8.11 Sq.m.

Total Area 1490 Sq.ft. / 138.42 Sq.m.

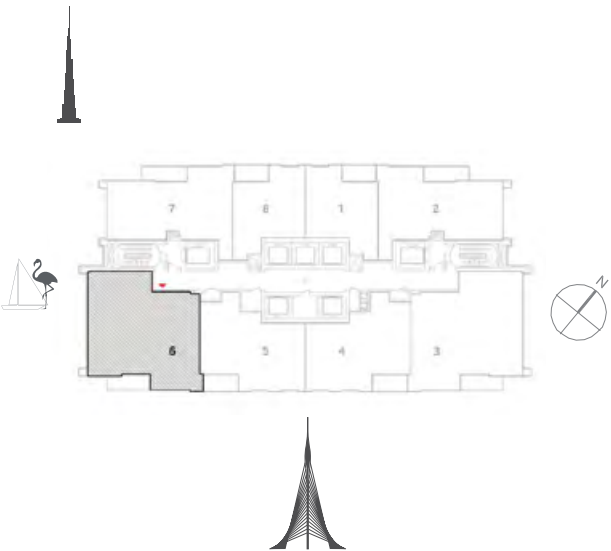

1. All dimensions are in imperial and metric, and measured to structural elements and exclude wall finishes and construction tolerances. 2. All materials, dimensions, and drawings are approximate only. 3. Information is subject to change without notice, at developer's absolute discretion. 4. Actual area may vary from the stated area. 5. Drawings not to scale. 6. All images used are for illustrative purposes only and do not represent the actual size, features, specifications, fittings, and furnishings. 7. The developer reserves the right to make revisions/ alterations, at its absolute discretion, without any liability whatsoever. \*Please note that landscaping and swimming pool are not provided by the developer.

DUBAI CREEK

HARBOUR

CREEK GATE



2 BEDROOM

WITH BALCONY

TOWER 1

UNIT 7 | LEVELS 3-17, 19-30

Suite Area	1018 Sq.ft. / 94.58 Sq.m.
Balcony Area	93 Sq.ft. / 8.60 Sq.m.
Total Area	1111 Sq.ft. / 103.18 Sq.m.

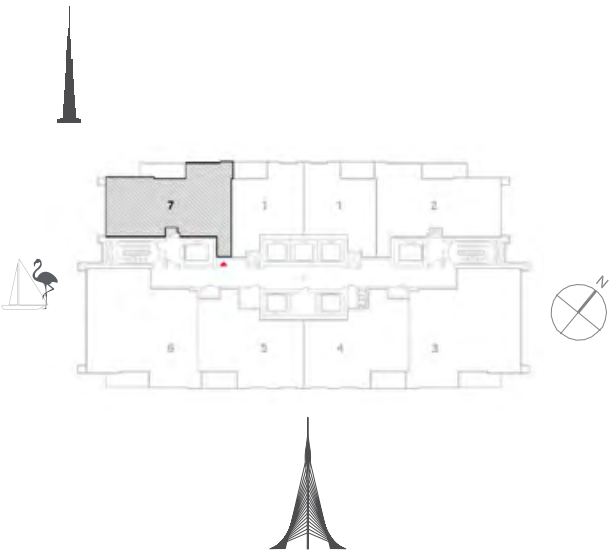

1. All dimensions are in imperial and metric, and measured to structural elements and exclude wall finishes and construction tolerances. 2. All materials, dimensions, and drawings are approximate only. 3. Information is subject to change without notice, at developer's absolute discretion. 4. Actual area may vary from the stated area. 5. Drawings not to scale. 6. All images used are for illustrative purposes only and do not represent the actual size, features, specifications, fittings, and furnishings. 7. The developer reserves the right to make revisions/ alterations, at its absolute discretion, without any liability whatsoever. \*Please note that landscaping and swimming pool are not provided by the developer.



# DUBAI CREEK

## HARBOUR

### CREEK GATE



## 1 BEDROOM WITH BALCONY

TOWER 1  
UNIT 8 | LEVELS 3-17, 19-30

Suite Area 645 Sq.ft. / 59.90 Sq.m.

Balcony Area 80 Sq.ft. / 7.42 Sq.m.

Total Area 725 Sq.ft. / 67.32 Sq.m.

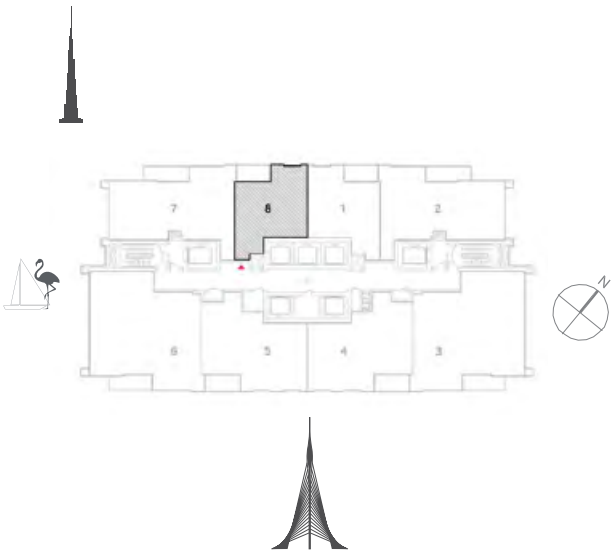

1. All dimensions are in imperial and metric, and measured to structural elements and exclude wall finishes and construction tolerances. 2. All materials, dimensions, and drawings are approximate only. 3. Information is subject to change without notice, at developer's absolute discretion. 4. Actual area may vary from the stated area. 5. Drawings not to scale. 6. All images used are for illustrative purposes only and do not represent the actual size, features, specifications, fittings, and furnishings. 7. The developer reserves the right to make revisions/ alterations, at its absolute discretion, without any liability whatsoever. \*Please note that landscaping and swimming pool are not provided by the developer.

# DUBAI CREEK

HARBOUR

---

CREEK GATE

For more information on **Creek Gate** in Dubai Creek Harbour, please call 800 36227(UAE) or +971 4 366 1668 (International).

Visit our online sales centre at [emaar.com](http://emaar.com) or any of our sales centres across the UAE.

## DUBAI:

Dubai Creek Harbour Sales Centre: Ras Al Khor

Emaar Sales Center, Downtown Dubai

Dubai Hills Estate Sales Pavillion: Umm Suqeim Road

## ABU DHABI:

Emaar Sales Centre: Al Nahda Tower, Ground Floor, 4th Street,  
Corniche, Al Muroor Road

Open from Saturday - Thursday, from 8.30am - 6.00pm



# خـور دـبي

## كريك جيت

للمزيد من المعلومات حول كريك جيت يرجى زيارتنا  
أو الاتصال بالرقم (٨٠٠٣٦٢٢٧) في الإمارات العربية المتحدة أو ٣٦٦ ١٦٦٨ ٤ ٩٧١ + (دولي)  
أو قم بزيارة مركز مبيعاتنا الإلكتروني على الموقع [emaar.com](http://emaar.com)

دبي

مركز مبيعات خور دبي في رأس الخور  
مركز مبيعات إعمار في وسط مدينة دبي  
مركز مبيعات دبي هيلز استيت على طريق أم سقيم

أبوظبي

مركز مبيعات إعمار في برج النهضة، الشارع الرابع،  
الكورنيش، طريق المرور - أبوظبي

السبت إلى الخميس من الساعة ٨:٣٠ صباحاً حتى الساعة ٦ مساءً