

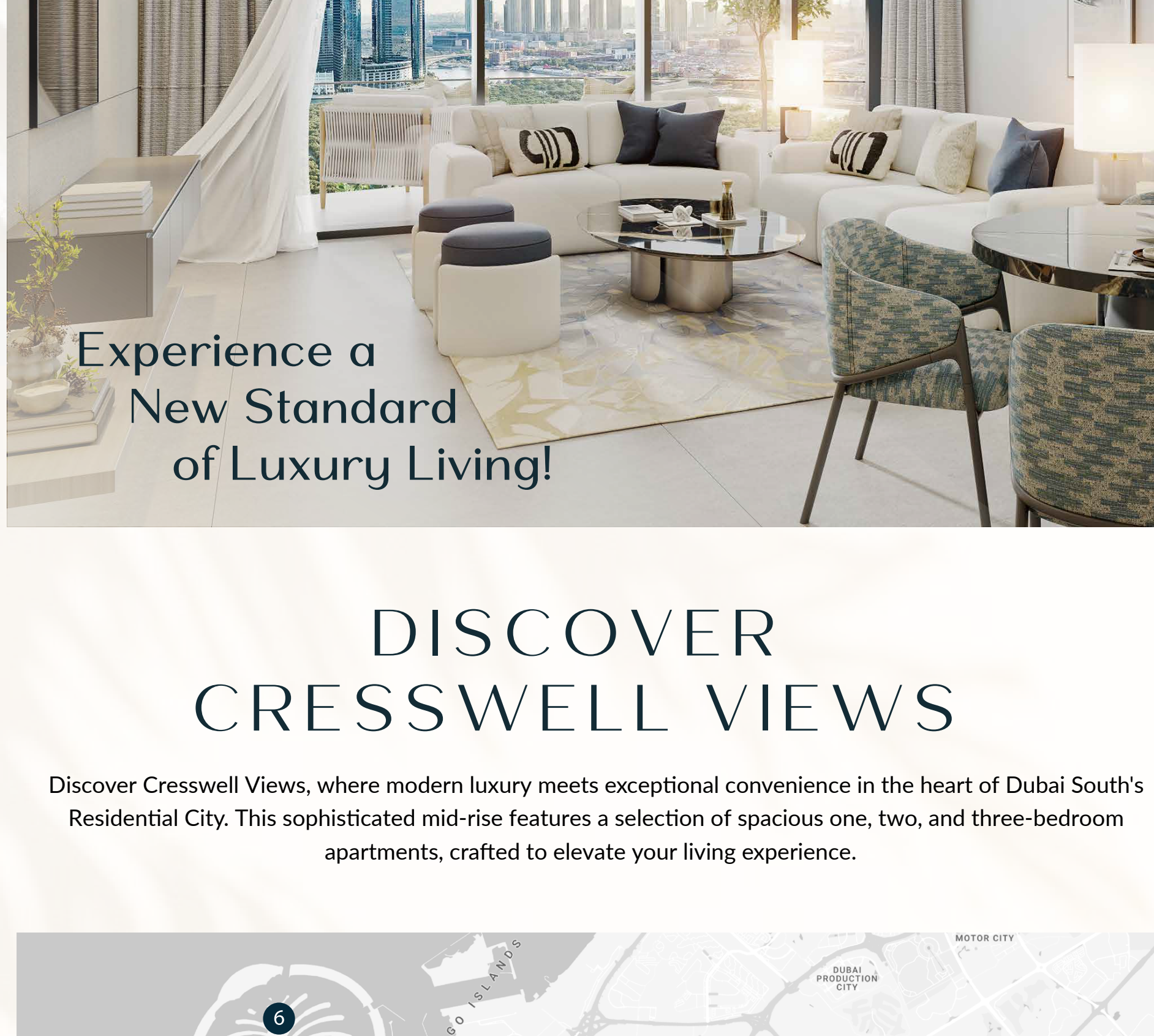

CRESSWELL VIEWS



Experience a
New Standard
of Luxury Living!

DISCOVER CRESSWELL VIEWS

Discover Cresswell Views, where modern luxury meets exceptional convenience in the heart of Dubai South's Residential City. This sophisticated mid-rise features a selection of spacious one, two, and three-bedroom apartments, crafted to elevate your living experience.

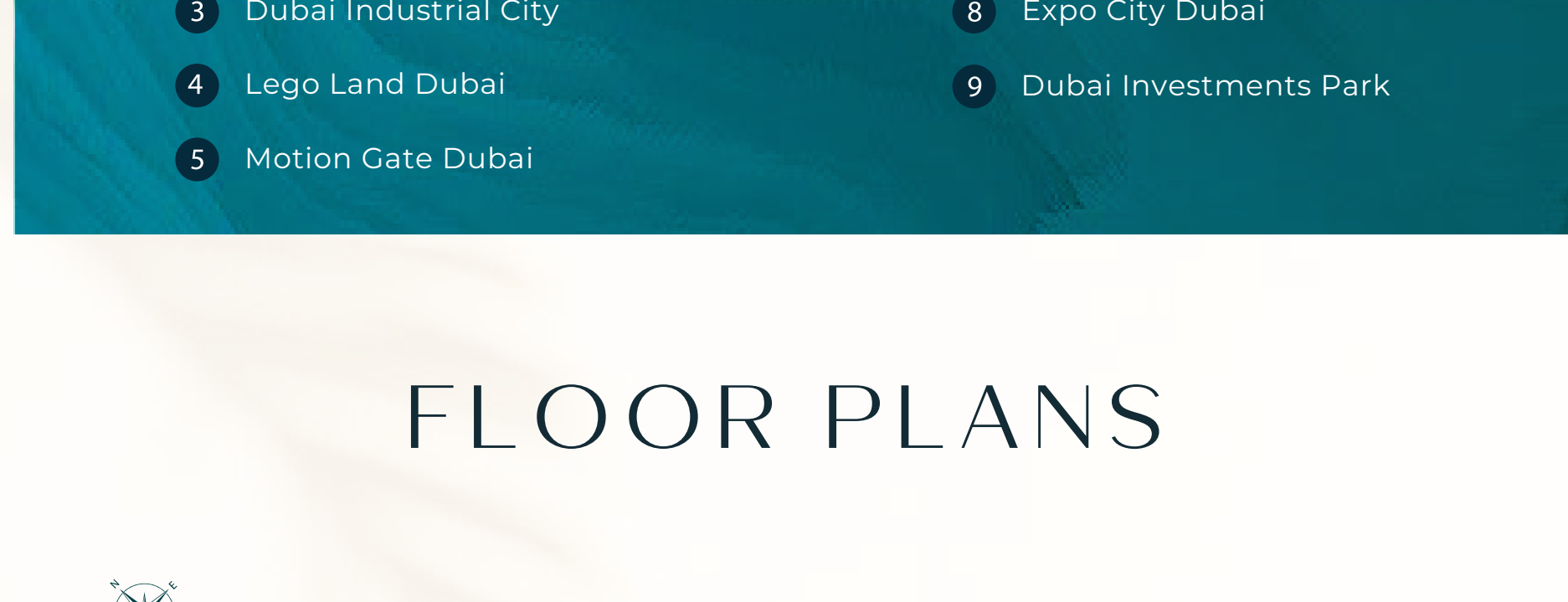

EXIT SERVICE ROAD ENTRY

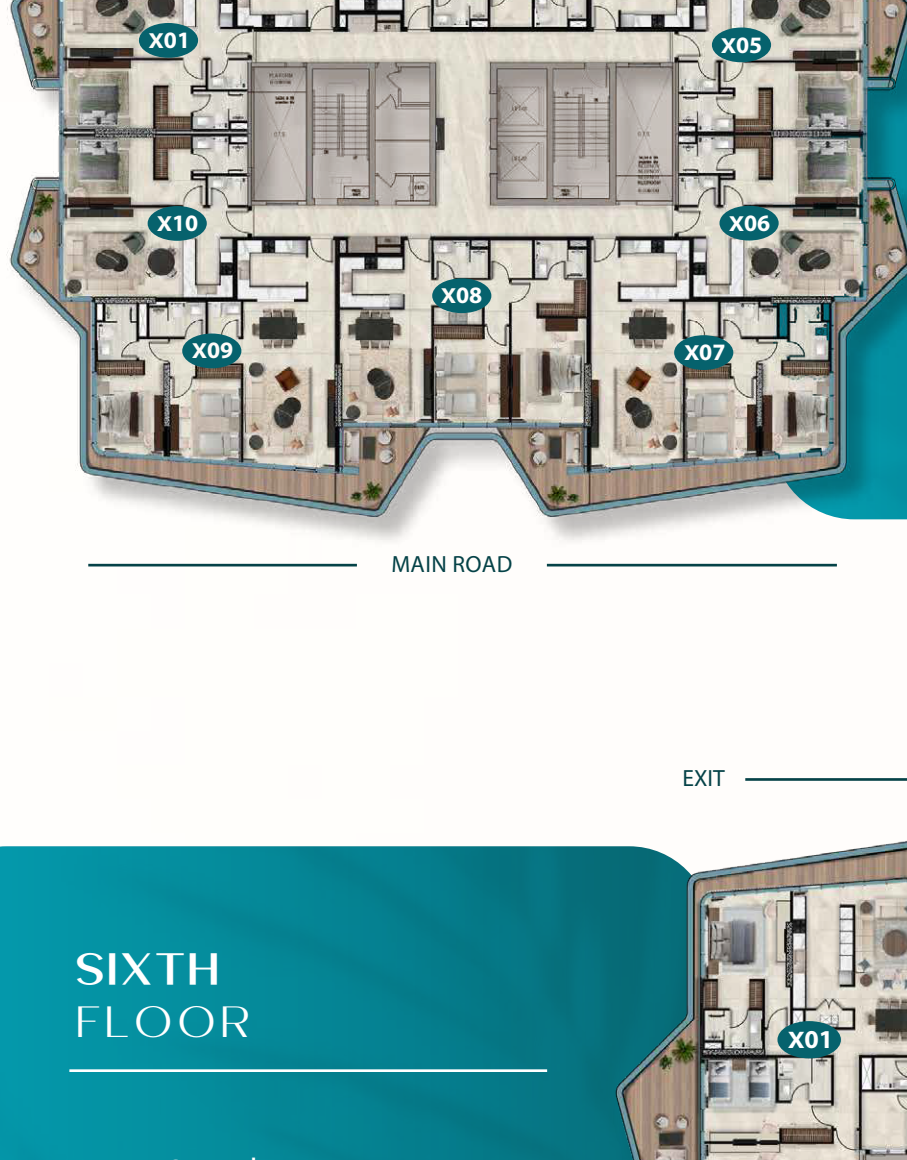

TYPICAL FLOORS FIRST TO FIFTH FLOOR

- 1 Bedroom
Starting Size
76.51 SQM
823 SQFT
- 2 Bedroom
121.94 SQM
1312 SQFT

MAIN ROAD

EXIT SERVICE ROAD ENTRY

SIXTH FLOOR

- 2 Bedroom
128.93 SQM
1387 SQFT
- 3 Bedroom
199.92 SQM
2152 SQFT



MAIN ROAD

EXIT SERVICE ROAD ENTRY



SEVENTH FLOOR AMENITIES

- Gymnasium
- Swimming Pool
- Kids Outdoor Play Area
- Outdoor Garden
- Outdoor BBQ Lounge

MAIN ROAD

RESIDENTIAL UNITS

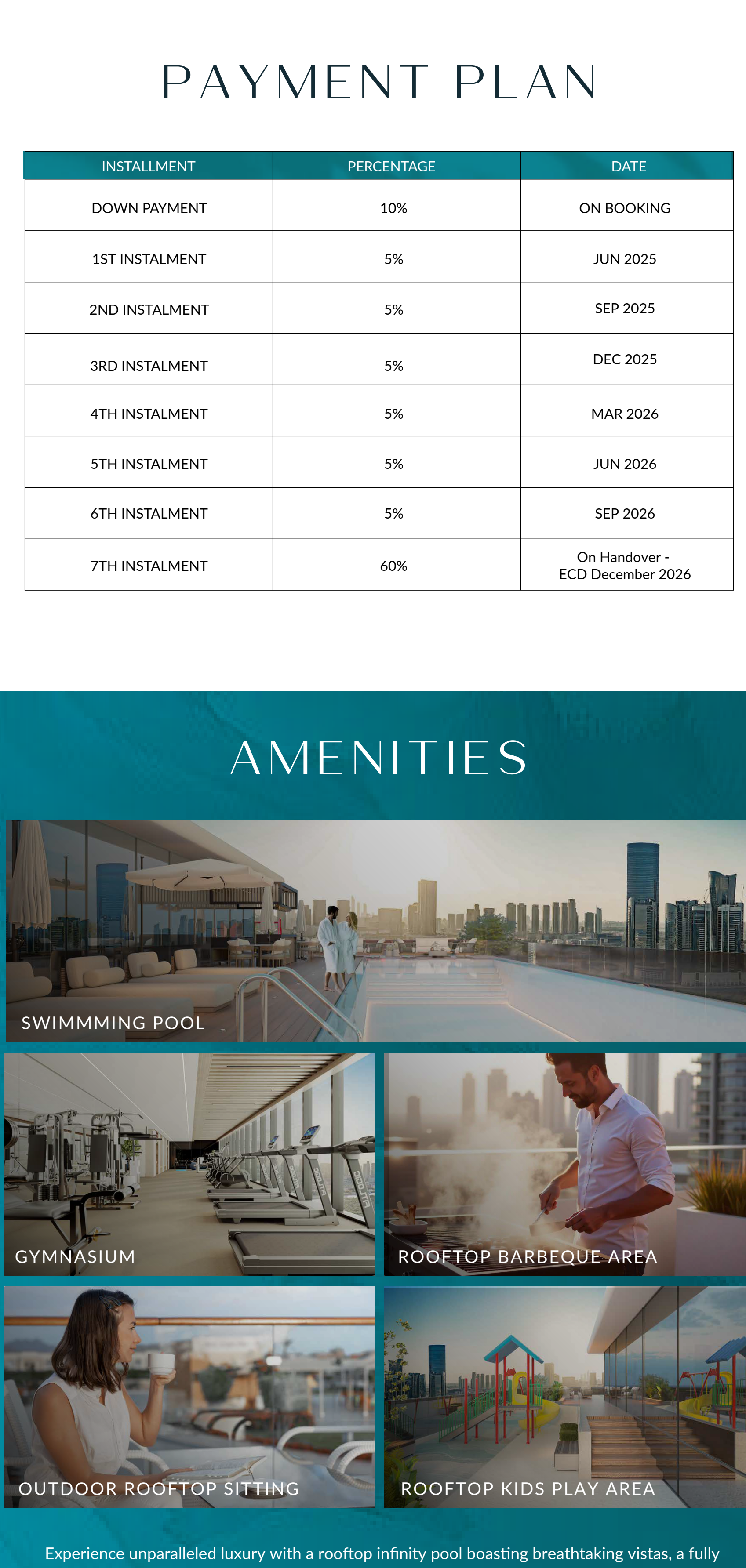

NO. OF BEDROOMS	UNITS	MIN BUA (SQFT)	STARTING PRICE FROM (AED)
1	20	823	894,000
2	32	1,312	1.46 MN
3	4	2,151	2.3 MN



PAYMENT PLAN

INSTALLMENT	PERCENTAGE	DATE
DOWN PAYMENT	10%	ON BOOKING
1ST INSTALMENT	5%	JUN 2025
2ND INSTALMENT	5%	SEP 2025
3RD INSTALMENT	5%	DEC 2025
4TH INSTALMENT	5%	MAR 2026
5TH INSTALMENT	5%	JUN 2026
6TH INSTALMENT	5%	SEP 2026
7TH INSTALMENT	60%	On Handover - ECD December 2026

AMENITIES

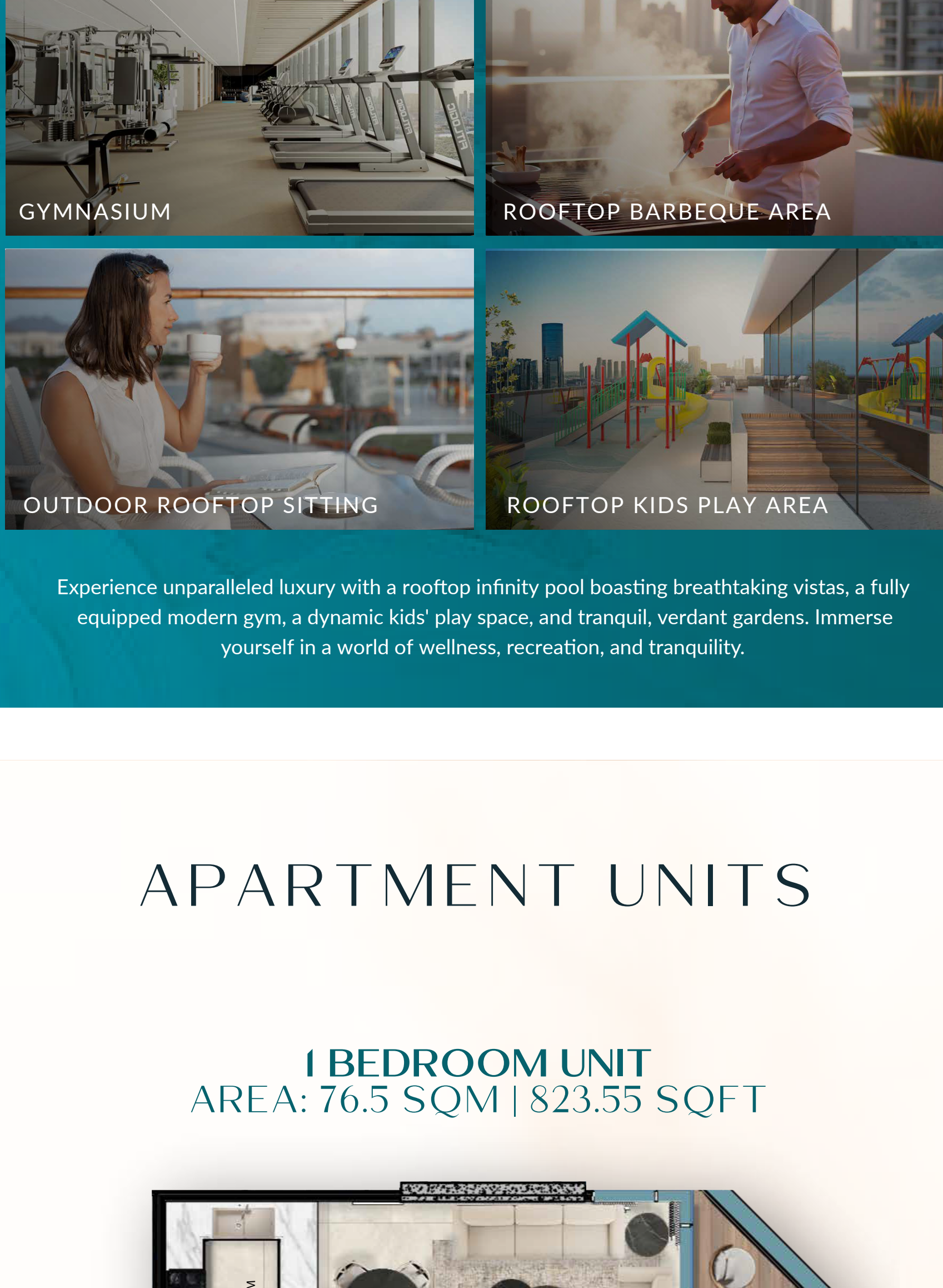

Experience unparalleled luxury with a rooftop infinity pool boasting breathtaking vistas, a fully equipped modern gym, a dynamic kids' play space, and tranquil, verdant gardens. Immerse yourself in a world of wellness, recreation, and tranquility.

APARTMENT UNITS

1 BEDROOM UNIT AREA: 76.5 SQM | 823.55 SQFT

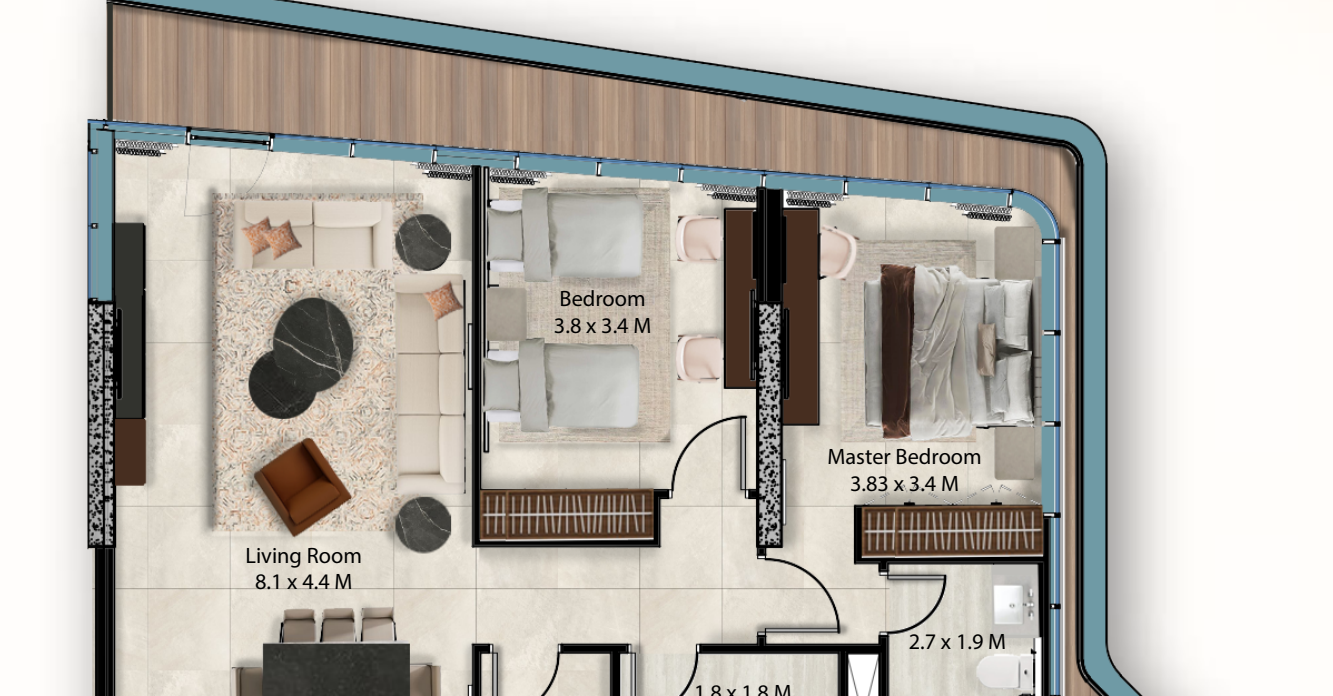

TYPE 1 2 BEDROOMS UNIT AREA: 122 SQM | 1312 SQFT



TYPE 2 2 BEDROOMS UNIT AREA: 129 SQM | 1387 SQFT



3 BEDROOMS UNIT AREA: 200 SQM | 2152 SQFT

