



SOLENA

@

THE ORCHARD PLACE

*F*ACTSHEET





# EUROPEAN INSPIRED LIVING IN JVC

Solena at The Orchard Place introduces a new era in modern European living, where every detail whispers elegance.

Inspired by serene Mediterranean vineyards, Solena brings the radiance of European gardens to the vibrant city of Dubai.

Located in the heart of JVC, this enviable residential and lifestyle community is a vision of urban sophistication, harmonising serenity with modern charm.

Nestled amidst the tree-lined boulevards of Jumeirah Village Circle, Solena, offers the best of both worlds, a sense of community and connectivity.

Enjoy effortless access to hotels, alfresco cafés, schools, hospitals, parks, sports amenities and shopping boutiques.





# A STRATEGIC LOCATION

## DISTRICT 12, JVC

- |                            |         |                                    |         |
|----------------------------|---------|------------------------------------|---------|
| • Ladybird Kindergarten    | 2 mins  | • Dubai Autodrome                  | 10 mins |
| • Five Hotel JVC           | 3 mins  | • Mall of the Emirates             | 15 mins |
| • Circle Mall              | 5 mins  | • Dubai Marina                     | 15 mins |
| • JSS International School | 7 mins  | • Global Village                   | 15 mins |
| • Brighton College Dubai   | 7 mins  | • The Palm Jumeirah                | 20 mins |
| • GEMS Founders School     | 7 mins  | • Downtown Dubai / Burj Khalifa    | 20 mins |
| • The Royal Grammar School | 10 mins | • Safa Park                        | 20 mins |
| • Guildford Dubai          |         | • Dubai International Airport      | 30 mins |
| • Sports City              | 10 mins | • Al Maktoum International Airport | 30 mins |
| • Dubai Miracle Garden     | 10 mins |                                    |         |





# PROJECT OVERVIEW

Choose from timeless studios, one- and two-bedroom residences and three-bedroom penthouses built to high standards with premium finishes and quality appliances.

Each home is shaped by Mediterranean influences, light-washed spaces, clean lines and timeless artistry that celebrates graceful living.

A symphony of modern luxury and European design, each residence offers an opulent lifestyle framed by breathtaking views and curated experiences.

From private apartment pools and yoga terraces to padel tennis courts, barbecue gardens and more, every amenity is thoughtfully designed to elevate daily life into something extraordinary.



## BUILDING OVERVIEW

2 Towers (Tower D & E)

## PROPERTY TYPES

Studios, 1 & 2 bed apartments & 3 bed penthouses

## SIZE RANGES

UNITS	MIN SIZE	MAX SIZE
Studios	531 sq.ft	531 sq.ft
1 beds	688 sq.ft	920 sq.ft
2 beds	1,050 sq.ft	1,337 sq.ft
3 bed penthouses	2,106 sq ft	3,128 sq f

## PAYMENT PLAN

10%

Down Payment

40%

During Construction

50%

On Handover

## COMPLETION DATE

Q2 2028

## DEVELOPER

Peak Summit Real Estate Development LLC





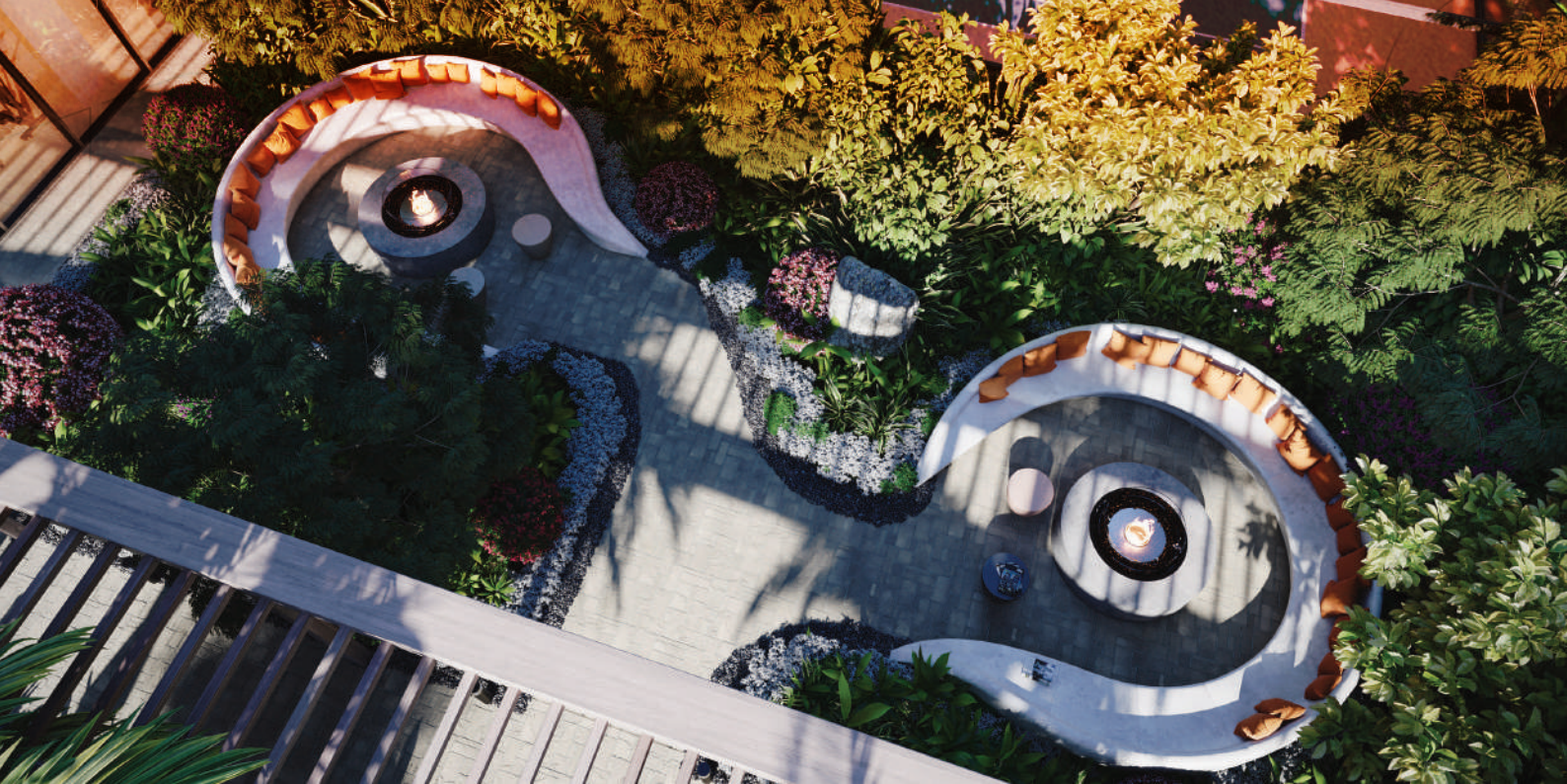

# PAYMENT SCHEDULE

INSTALMENTS	PERCENTAGE	PAYMENTS
(DP) Booking	10%	On Booking
DLD Registration	4%	On Booking
2nd Instalment	10%	30 Days from Booking Date
3rd Instalment	5%	90 Days from 2nd Instalment
4th Instalment	5%	90 Days from 3rd Instalment
5th Instalment	5%	90 Days from 4th Instalment
6th Instalment	2.5%	90 Days from 5th Instalment
7th Instalment	2.5%	90 Days from 6th Instalment
8th Instalment	2.5%	90 Days from 7th Instalment
9th Instalment	2.5%	90 Days from 8th Instalment
10th Instalment	2.5%	90 Days from 9th Instalment
11th Instalment	2.5%	90 Days from 10th Instalment
Final Instalment Anticipated Completion Date	50%	Anticipated Completion Date (Fixed)





# ENJOY WORLD-CLASS AMENITIES

- Landscaped gardens & green courtyards
- Landscaped terraces with firepits and lounge seating
- Adults' & children's swimming pool
- Play zones for children
- State-of-the-art gym & yoga terrace
- Padel tennis court
- Steam rooms
- Lockers & private shower facilities
- Outdoor seating spaces
- BBQ areas for alfresco dining
- Contemporary artistic lobby
- Meeting spaces
- Private covered parking





# SOLENA

@

THE ORCHARD PLACE





# QUALITY SPECIFICATIONS

## KITCHENS

- Bosch branded appliances
- Modern glossy sintered stone countertops and backsplashes
- White semi-matte kitchen cabinetry

## BATHROOMS

- Porcelain floor and wall tiles
- Sienna cherry flamed wood veneer cabinets
- Glossy sintered stone countertops and backsplashes
- Walk-in showers with high-quality accessories

## FLOORING

- Herringbone SPC wood-effect flooring in living / dining room and bedrooms
- Glazed porcelain tiles in kitchen, bathrooms and powder rooms

## TERRACES

- Natural beige, matte floor tiles







SOLENA

@

THE ORCHARD PLACE

DEVELOPED BY

**PEAK SUMMIT**

REAL ESTATE DEVELOPMENT LLC.

POWERED BY

**refine**