

# MAYAS SEA VIEW

## Dubai Islands



### The Community

Mayas Sea view is located at Dubai Islands, off the coast of Deira and contains a collection of 5 islands with a total area of 17 square kilometers. With approximately 20 km of beaches this location is perfect for those to enjoy sun, sand beaches.

Previously known as deira Islands, this waterfront city consists of man-made islands which are connected to each other by bridges. The area consists of hotels, residential buildings, restaurants, retail, and several sports.

The project Location was designed along Dubai's 2040 vision, with the intention of making the Dubai Islands one of the eye catchers of the city. The modern beach residences offer resort experiences and residents will experience that atmosphere.

The vicinity area is a vacation hub flowing with serenity, with water parks and theme parks will add a whole dimension of fun and attractions to the Island.

### The Mayas Sea View?

- Surrounded by panoramic views of the sea
- Attractive payment plan 5 years post handover payment plan 3 years
- Attractive price per square ft.
- Service charges – 1<sup>st</sup> year = 12-16AED
- Equipped with a wide range of amenities
- Near public open beach
- Prime location & Luxury neighborhood/RIXOS
- Malls nearby/Hotels-RIU palace, Centara
- Brands and luxury Finishes



- 6 mins to Infinity Bridge
- 19 mins to Cruise Terminal
- 18 mins to Dubai International Airport
- 26 mins to Downtown Dubai
- 25 mins to Dubai Mall
- The Exclusive community provide easy access to the City's vibrant heart including mall, beach and hotels while preserving the sense of privacy and seclusion.
- Mayas Sea View is located in one of Dubai's most desirable addresses, offering a prime location that redefines prestige and convenience. Residents can enjoy a harmonious blend of luxurious living and natural beauty, with breathtaking views of the shimmering waterfront becoming an integral part of their daily lives.

### The Developer

**SAMA MAYAS** is a real estate developer that focused on creating modern homes with high-quality materials and amenities at reasonable prices, ensuring a good investment return for clients.

We pledge to provide access to high end lifestyle with everything they require in one place for home buyers and residents in our developments.

Available Units	Area Sq Ft.		Price AED	
	MIN	MAX	MIN	MAX
1 BEDROOM	853	1,212	1,406,000	2,523,000
2 BEDROOM	1,452	1,743	2,323,000	4,008,000
3 BEDROOM DUPLEX	3,165	3,466	6,962,000	7,625,000

Note: Prices are subject to change by developer

### Facts

- G+8 Residential Apartment
- 63 Total Number of apartments
- 1 Bedroom; 49 nos.
- 2 Bedrooms; 12 nos.
- 3 Bedrooms (Duplex); 2 nos.

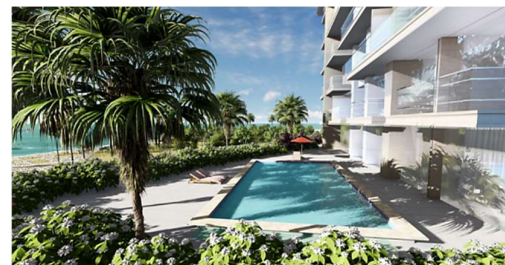

### Amenities



- Swimming pool
- Party Area
- Fitness Gym
- Indoor Cinema
- Sports Area
- Barbeque Area
- Mini Bar Area
- Sauna Room
- Kid's Play Area

### Residential Units

- 1 Bedroom
- 2 Bedroom
- 3 Bedroom Duplex

### Payment Plan

Installment	Payment Percentage
Upon Booking	20%
During Construction	50%
Post Handover Payments over 3 years	30%

Note: Payment plan are subject to change by developer

ESTIMATED CONSTRUCTION COMPLETION DATE

Q4 2026