

TOWER E

UNIT PLAN LAYOUTS

2 BEDROOM APARTMENT

TYPE B (with maid room + balcony) VARIANT 2

TOTAL SALEABLE AREA

SUITE = 1,081.08 SQ.FT.

BALCONY = 51.49 SQ.FT.

TOTAL = 1,132.57 SQ.FT.

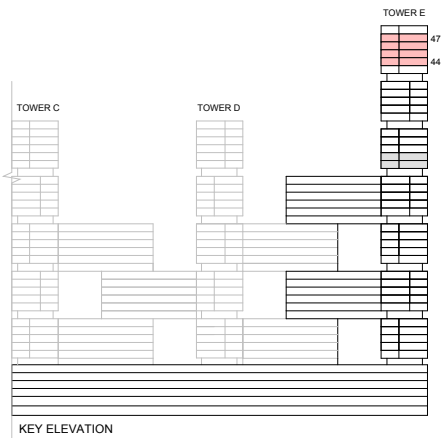

List of unit numbers with this unit plan:

VIEWS

Downtown, Ras Al Khor
E4401, E4501, E4601, E4701

Disclaimer: 1. All dimensions are in metric, measured to wall finishes. 2. All materials, dimensions & drawings are approximate. 3. Information is subject to change without notice, at developer's absolute discretion. 4. Actual area may vary from the stated area. 5. Drawing are not to scale. 6. All images used are for illustrative purpose only and do not represent the actual size, features, specifications, fittings and furnishings. 7. The developer reserves the right to make revisions/ alterations, at its absolute discretion, without any liability whatsoever.

2 BEDROOM APARTMENT

TYPE B (with maid room + balcony) VARIANT 2

TOTAL SALEABLE AREA

SUITE = 1,081.08 SQ.FT.

BALCONY = 51.49 SQ.FT.

TOTAL = 1,132.57 SQ.FT.

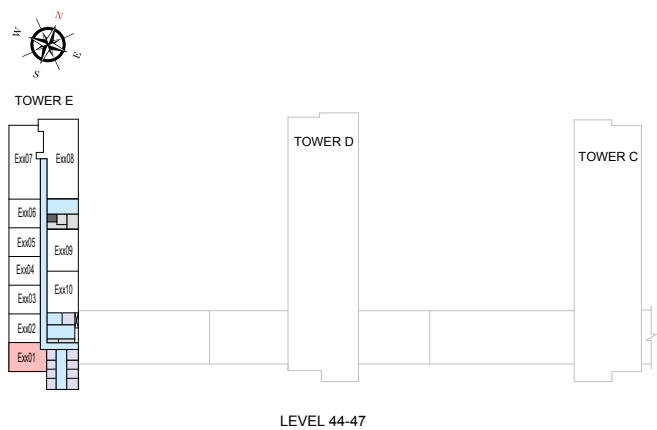

List of unit numbers with this unit plan:

VIEWS

Downtown, Ras Al Khor
E4401, E4501, E4601, E4701

Disclaimer: 1. All dimensions are in metric, measured to wall finishes. 2. All materials, dimensions & drawings are approximate. 3. Information is subject to change without notice, at developer's absolute discretion. 4. Actual area may vary from the stated area. 5. Drawing are not to scale. 6. All images used are for illustrative purpose only and do not represent the actual size, features, specifications, fittings and furnishings. 7. The developer reserves the right to make revisions/ alterations, at its absolute discretion, without any liability whatsoever.

2 BEDROOM APARTMENT
TYPE H (with maid room + yard) VARIANT 2

TOTAL SALEABLE AREA
SUITE = 1,091.89 SQ.FT.
YARD = 261.56 SQ.FT.
TOTAL = 1,353.45 SQ.FT.

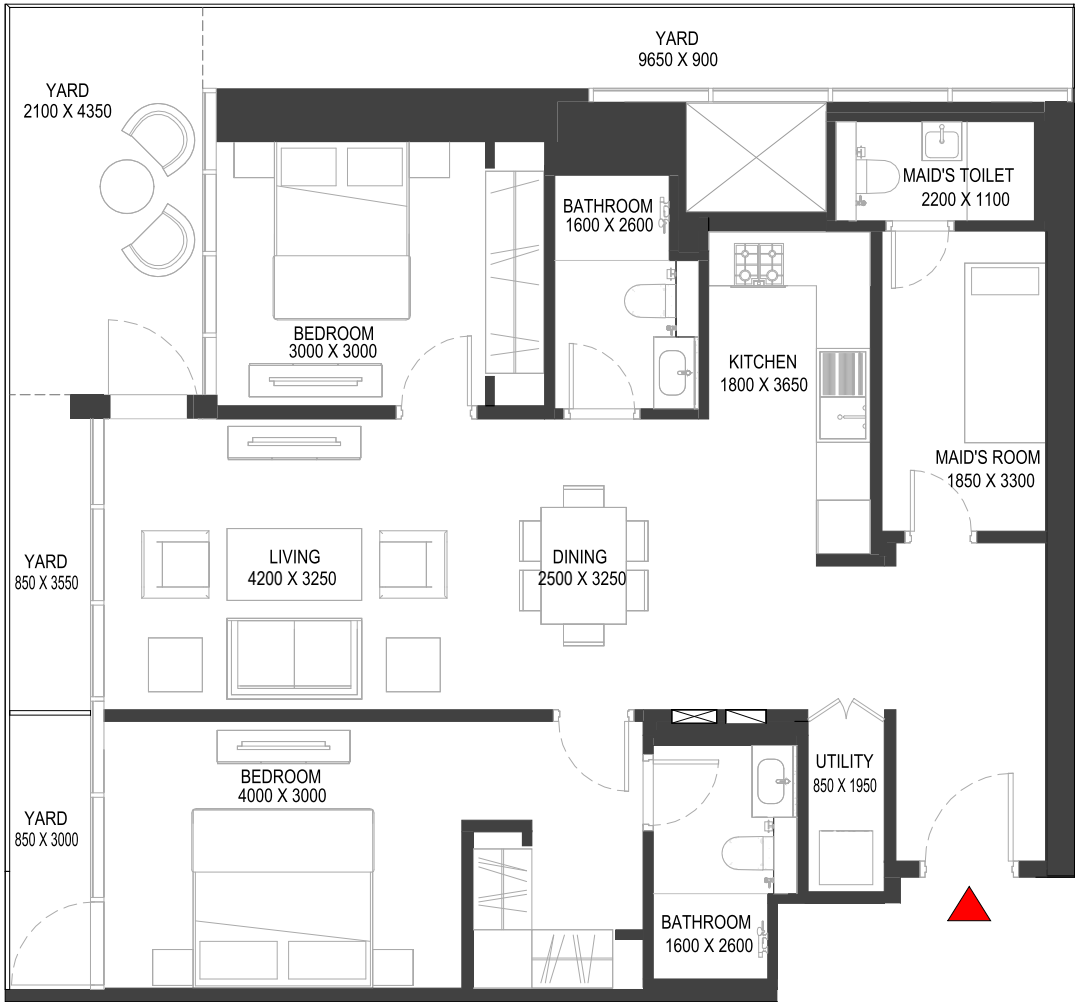
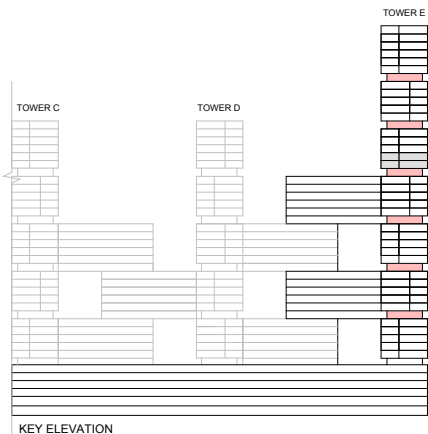

List of unit numbers with this unit plan:

VIEWS

Downtown, Ras Al Khor
E1201, E1801, E2401, E3001, E3601, E4201

Disclaimer: 1. All dimensions are in metric, measured to wall finishes. 2. All materials, dimensions & drawings are approximate. 3. Information is subject to change without notice, at developer's absolute discretion. 4. Actual area may vary from the stated area. 5. Drawing are not to scale. 6. All images used are for illustrative purpose only and do not represent the actual size, features, specifications, fittings and furnishings. 7. The developer reserves the right to make revisions/ alterations, at its absolute discretion, without any liability whatsoever.

2 BEDROOM APARTMENT
TYPE H (with maid room + yard) VARIANT 2

TOTAL SALEABLE AREA
SUITE = 1,091.89 SQ.FT.
YARD = 261.56 SQ.FT.
TOTAL = 1,353.45 SQ.FT.

UNIT

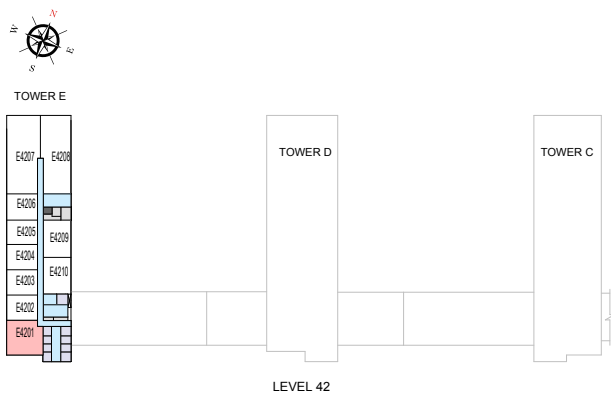
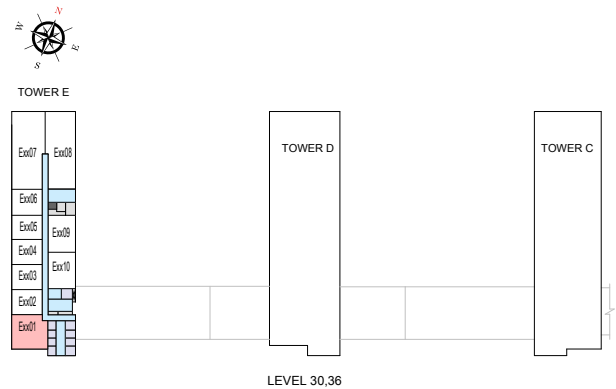
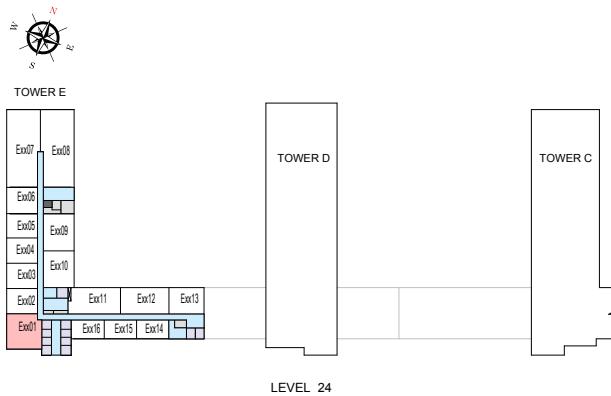
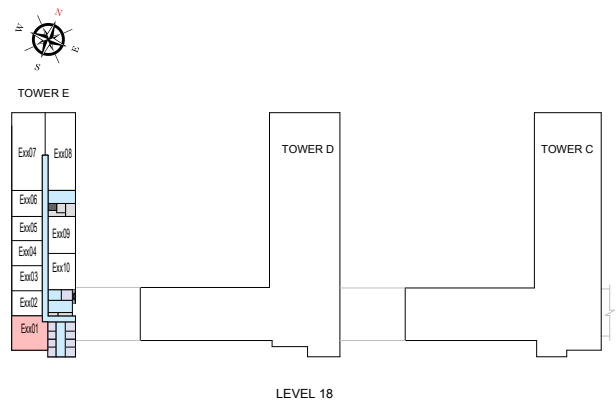
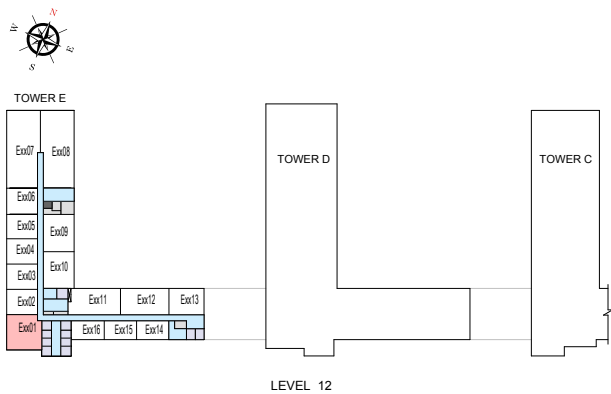

List of unit numbers with this unit plan:

VIEWS

Downtown, Ras Al Khor
E1201, E1801, E2401, E3001, E3601, E4201

Disclaimer: 1. All dimensions are in metric, measured to wall finishes. 2. All materials, dimensions & drawings are approximate. 3. Information is subject to change without notice, at developer's absolute discretion. 4. Actual area may vary from the stated area. 5. Drawing are not to scale. 6. All images used are for illustrative purpose only and do not represent the actual size, features, specifications, fittings and furnishings. 7. The developer reserves the right to make revisions/ alterations, at its absolute discretion, without any liability whatsoever.

2 BEDROOM APARTMENT
TYPE Q (with maid room + yard) VARIANT 2

TOTAL SALEABLE AREA
SUITE = 1,081.08 SQ.FT.
YARD = 257.69 SQ.FT.
TOTAL = 1,338.77 SQ.FT.

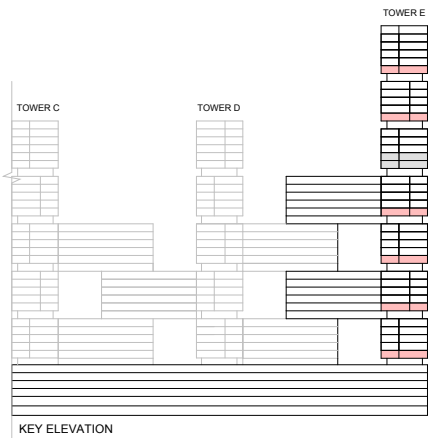

List of unit numbers with this unit plan:

VIEWS

Downtown, Ras Al Khor
E701, E1301, E1901, E2501, E3701, E4301

Disclaimer: 1. All dimensions are in metric, measured to wall finishes. 2. All materials, dimensions & drawings are approximate. 3. Information is subject to change without notice, at developer's absolute discretion. 4. Actual area may vary from the stated area. 5. Drawing are not to scale. 6. All images used are for illustrative purpose only and do not represent the actual size, features, specifications, fittings and furnishings. 7. The developer reserves the right to make revisions/ alterations, at its absolute discretion, without any liability whatsoever.

2 BEDROOM APARTMENT
TYPE Q (with maid room + yard) VARIANT 2

TOTAL SALEABLE AREA
SUITE = 1,081.08 SQ.FT.
YARD = 257.69 SQ.FT.
TOTAL = 1,338.77 SQ.FT.

UNIT

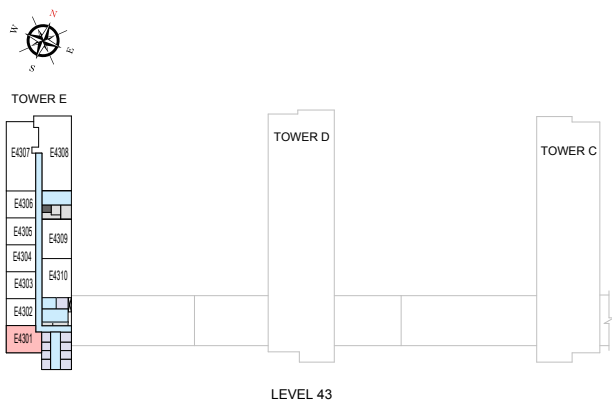
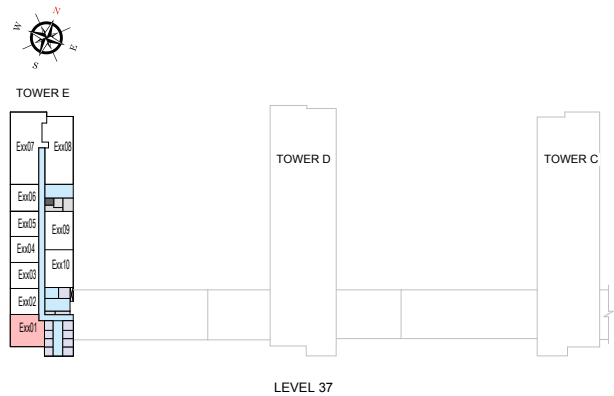
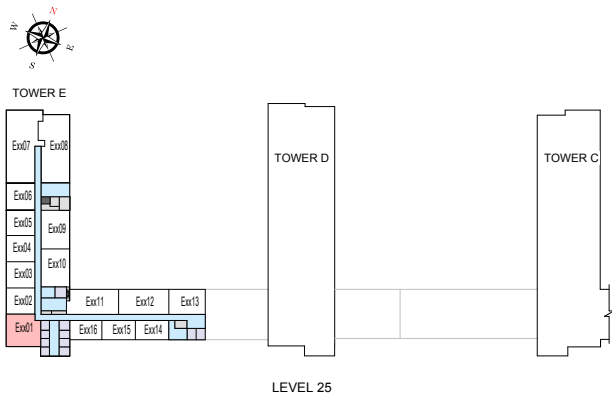
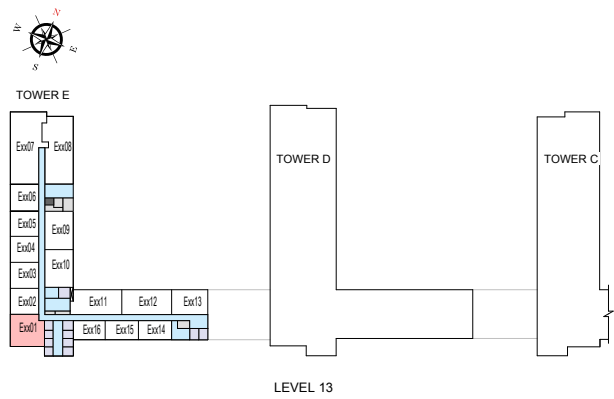
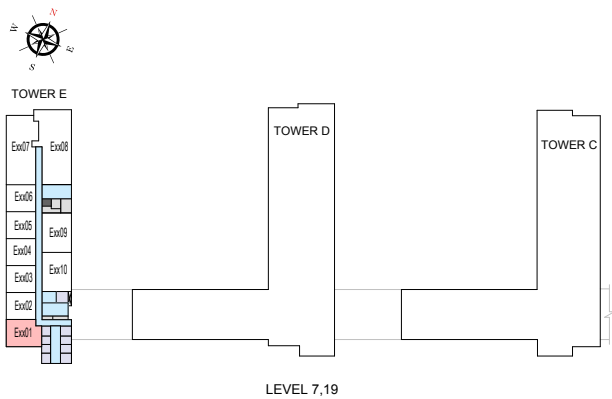

List of unit numbers with this unit plan:

VIEWS

Downtown, Ras Al Khor
E701, E1301, E1901, E2501, E3701, E4301

Disclaimer: 1. All dimensions are in metric, measured to wall finishes. 2. All materials, dimensions & drawings are approximate. 3. Information is subject to change without notice, at developer's absolute discretion. 4. Actual area may vary from the stated area. 5. Drawing are not to scale. 6. All images used are for illustrative purpose only and do not represent the actual size, features, specifications, fittings and furnishings. 7. The developer reserves the right to make revisions/ alterations, at its absolute discretion, without any liability whatsoever.

3 BEDROOM APARTMENT

TYPE C (with maid room, store room + yard)

TOTAL SALEABLE AREA
SUITE = 1,708.66 SQ.FT.
YARD = 782.86 SQ.FT.
TOTAL = 2,491.52 SQ.FT.

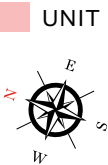
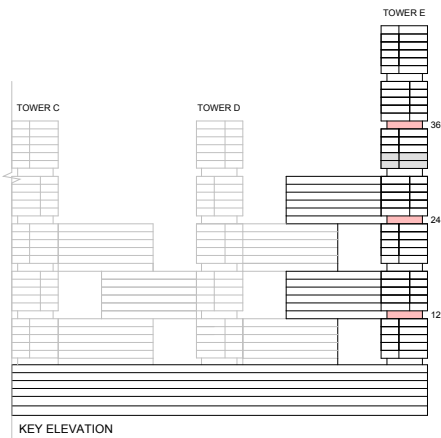

List of unit numbers with this unit plan:

VIEWS

Downtown, Ras Al Khor, Creek, Golf Course, Water body, Amenities
E1208, E2408

Downtown, Ras Al Khor, Creek, Golf Course, Water body
E3608

Disclaimer: 1. All dimensions are in metric, measured to wall finishes. 2. All materials, dimensions & drawings are approximate. 3. Information is subject to change without notice, at developer's absolute discretion. 4. Actual area may vary from the stated area. 5. Drawing are not to scale. 6. All images used are for illustrative purpose only and do not represent the actual size, features, specifications, fittings and furnishings. 7. The developer reserves the right to make revisions/ alterations, at its absolute discretion, without any liability whatsoever.

3 BEDROOM APARTMENT
TYPE C (with maid room, store room + yard)

TOTAL SALEABLE AREA
SUITE = 1,708.66 SQ.FT.
YARD = 782.86 SQ.FT.
TOTAL = 2,491.52 SQ.FT.

UNIT

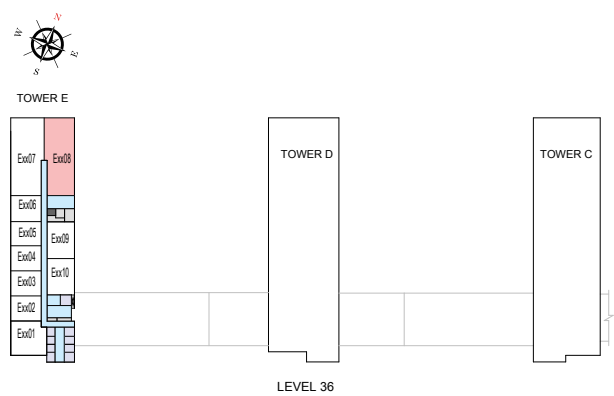
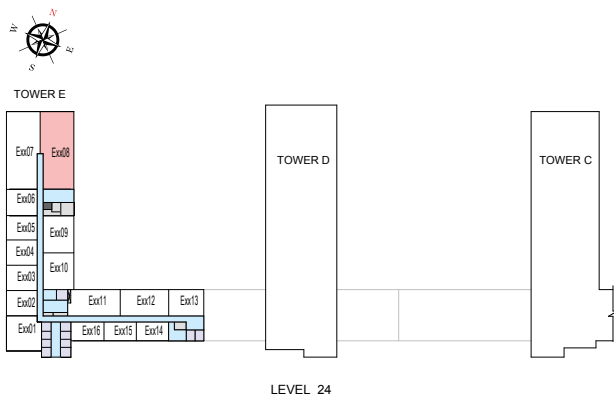
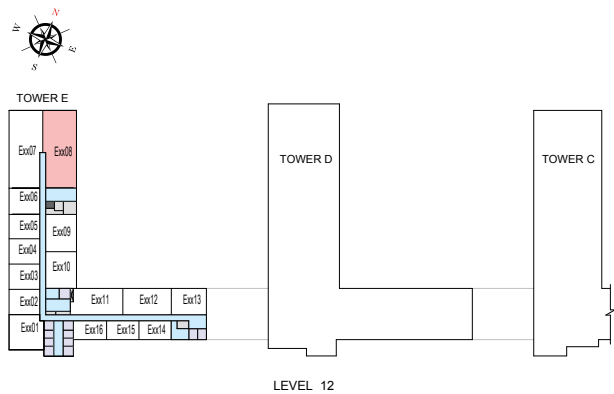

List of unit numbers with this unit plan:

VIEWS

Downtown, Ras Al Khor, Creek, Golf Course, Water body, Amenities
E1208, E2408

Downtown, Ras Al Khor, Creek, Golf Course, Water body
E3608

Disclaimer: 1. All dimensions are in metric, measured to wall finishes. 2. All materials, dimensions & drawings are approximate. 3. Information is subject to change without notice, at developer's absolute discretion. 4. Actual area may vary from the stated area. 5. Drawing are not to scale. 6. All images used are for illustrative purpose only and do not represent the actual size, features, specifications, fittings and furnishings. 7. The developer reserves the right to make revisions/ alterations, at its absolute discretion, without any liability whatsoever.

3 BEDROOM APARTMENT

TYPE C (with maid room, store room + yard) VARIANT 1

TOTAL SALEABLE AREA

SUITE = 1,708.66 SQ.FT.

YARD = 782.86 SQ.FT.

TOTAL = 2,491.52 SQ.FT.

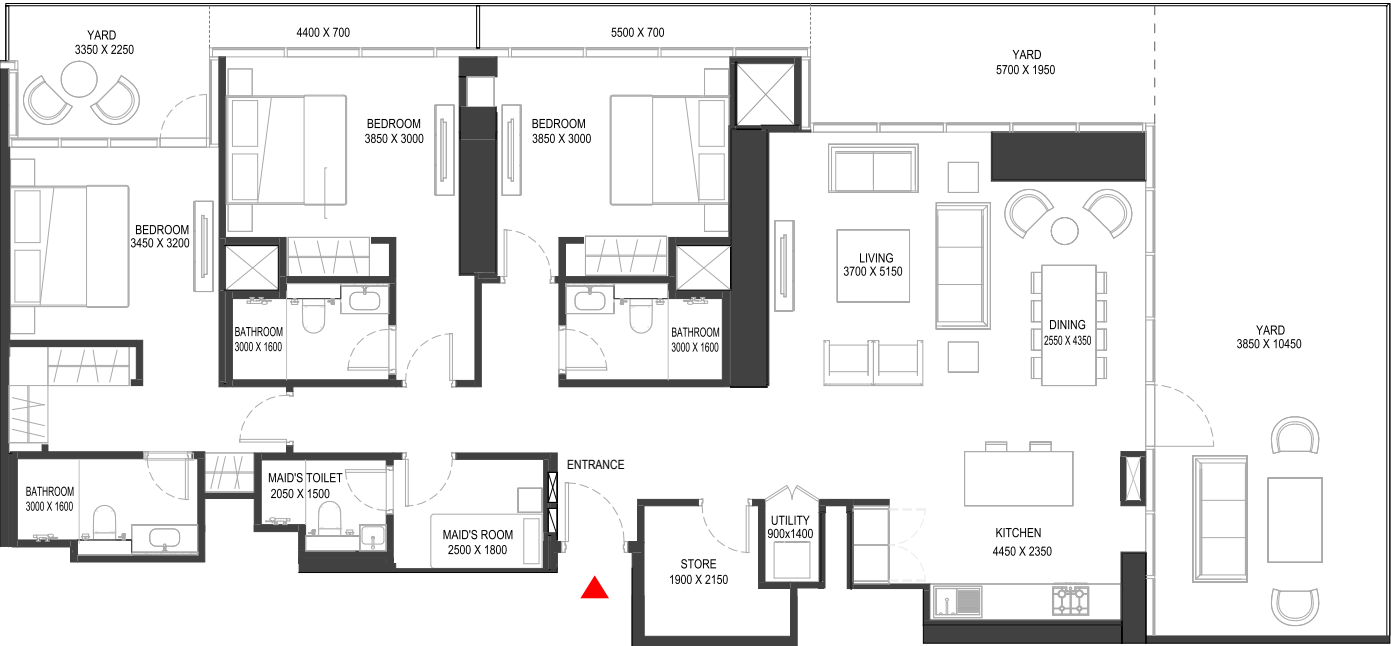
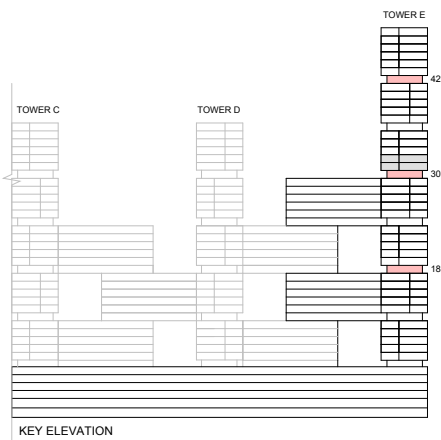

List of unit numbers with this unit plan:

VIEWS

Downtown, Ras Al Khor, Creek, Golf Course, Water body
E1807, E3007, E4207

Disclaimer: 1. All dimensions are in metric, measured to wall finishes. 2. All materials, dimensions & drawings are approximate. 3. Information is subject to change without notice, at developer's absolute discretion. 4. Actual area may vary from the stated area. 5. Drawing are not to scale. 6. All images used are for illustrative purpose only and do not represent the actual size, features, specifications, fittings and furnishings. 7. The developer reserves the right to make revisions/ alterations, at its absolute discretion, without any liability whatsoever.

3 BEDROOM APARTMENT

TYPE C (with maid room, store room + yard) VARIANT 1

TOTAL SALEABLE AREA

SUITE = 1,708.66 SQ.FT.

YARD = 782.86 SQ.FT.

TOTAL = 2,491.52 SQ.FT.

UNIT

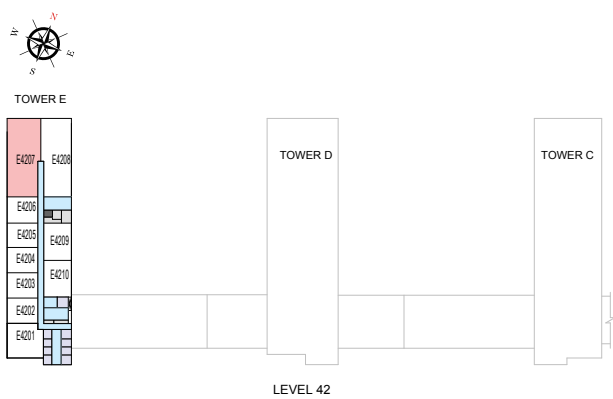
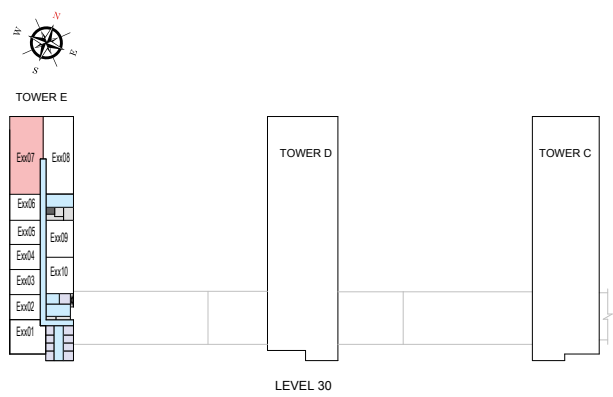
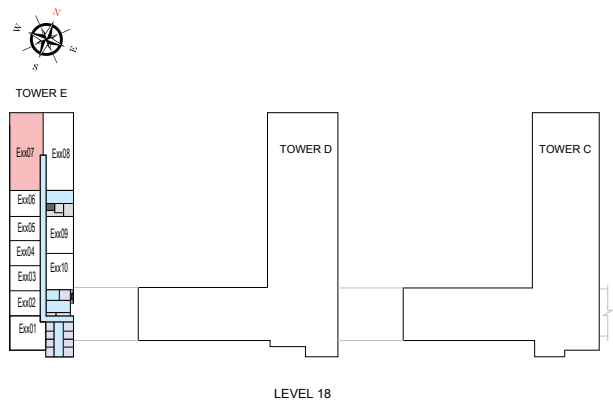

List of unit numbers with this unit plan:

VIEWS

Downtown, Ras Al Khor, Creek, Golf Course, Water body
E1807, E3007, E4207

Disclaimer: 1. All dimensions are in metric, measured to wall finishes. 2. All materials, dimensions & drawings are approximate. 3. Information is subject to change without notice, at developer's absolute discretion. 4. Actual area may vary from the stated area. 5. Drawing are not to scale. 6. All images used are for illustrative purpose only and do not represent the actual size, features, specifications, fittings and furnishings. 7. The developer reserves the right to make revisions/ alterations, at its absolute discretion, without any liability whatsoever.

3 BEDROOM APARTMENT
TYPE D (with maid room, store room + yard)

TOTAL SALEABLE AREA
SUITE = 1,708.66 SQ.FT.
YARD = 536.04 SQ.FT.
TOTAL = 2,244.70 SQ.FT.

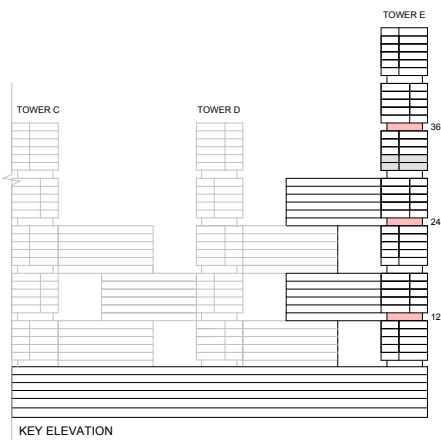

List of unit numbers with this unit plan:

VIEWS

Downtown, Ras Al Khor, Creek, Golf Course, Water body
E1207, E2407, E3607

Disclaimer: 1. All dimensions are in metric, measured to wall finishes. 2. All materials, dimensions & drawings are approximate. 3. Information is subject to change without notice, at developer's absolute discretion. 4. Actual area may vary from the stated area. 5. Drawing are not to scale. 6. All images used are for illustrative purpose only and do not represent the actual size, features, specifications, fittings and furnishings. 7. The developer reserves the right to make revisions/ alterations, at its absolute discretion, without any liability whatsoever.

3 BEDROOM APARTMENT
TYPE D (with maid room, store room + yard)

TOTAL SALEABLE AREA
SUITE = 1,708.66 SQ.FT.
YARD = 536.04 SQ.FT.
TOTAL = 2,244.70 SQ.FT.

UNIT

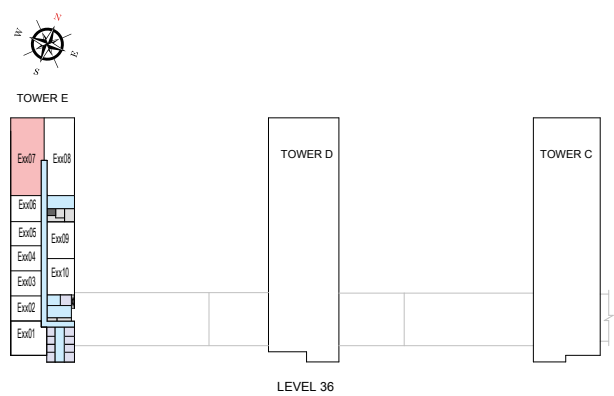
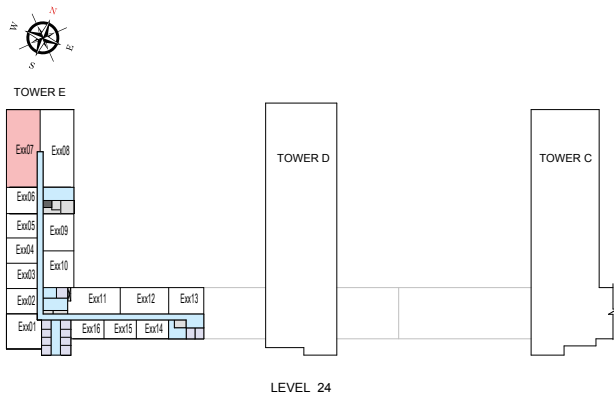
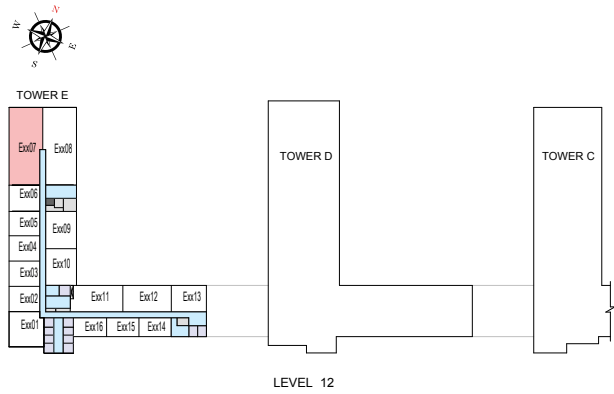

List of unit numbers with this unit plan:

VIEWS

Downtown, Ras Al Khor, Creek, Golf Course, Water body
E1207, E2407, E3607

Disclaimer: 1. All dimensions are in metric, measured to wall finishes. 2. All materials, dimensions & drawings are approximate. 3. Information is subject to change without notice, at developer's absolute discretion. 4. Actual area may vary from the stated area. 5. Drawing are not to scale. 6. All images used are for illustrative purpose only and do not represent the actual size, features, specifications, fittings and furnishings. 7. The developer reserves the right to make revisions/ alterations, at its absolute discretion, without any liability whatsoever.

3 BEDROOM APARTMENT

TYPE D (with maid room, store room + yard) VARIANT 1

TOTAL SALEABLE AREA

SUITE = 1,708.66 SQ.FT.

YARD = 536.04 SQ.FT.

TOTAL = 2,244.70 SQ.FT.

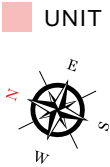
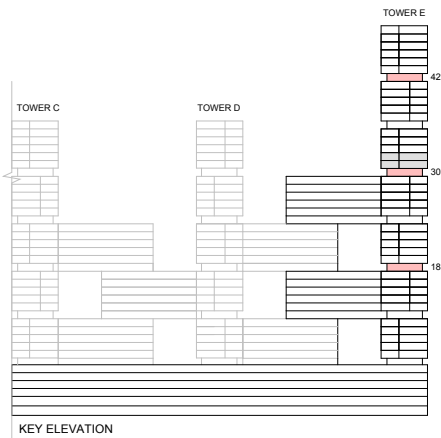

List of unit numbers with this unit plan:

VIEWS

Downtown, Ras Al Khor, Creek, Golf Course, Water body, Amenities
E1808

Downtown, Ras Al Khor, Creek, Golf Course, Water body
E3008, E4208

Disclaimer: 1. All dimensions are in metric, measured to wall finishes. 2. All materials, dimensions & drawings are approximate. 3. Information is subject to change without notice, at developer's absolute discretion. 4. Actual area may vary from the stated area. 5. Drawing are not to scale. 6. All images used are for illustrative purpose only and do not represent the actual size, features, specifications, fittings and furnishings. 7. The developer reserves the right to make revisions/ alterations, at its absolute discretion, without any liability whatsoever.

3 BEDROOM APARTMENT

TYPE D (with maid room, store room + yard VARIANT 1

TOTAL SALEABLE AREA

SUITE = 1,708.66 SQ.FT.

YARD = 536.04 SQ.FT.

TOTAL = 2,244.70 SQ.FT.

UNIT

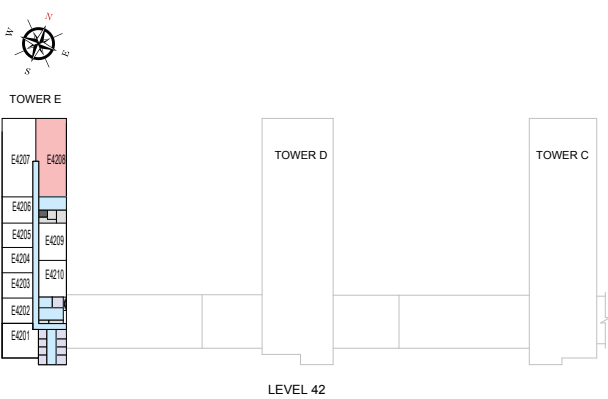
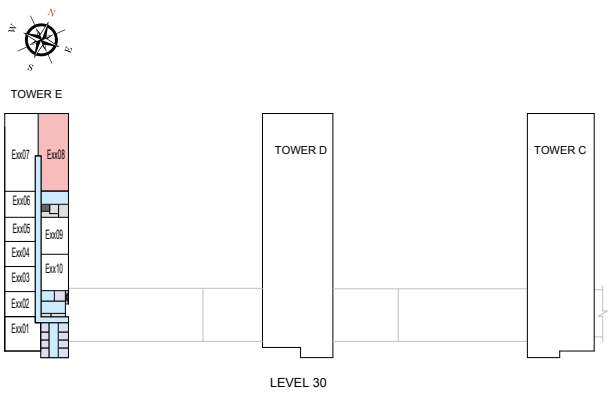
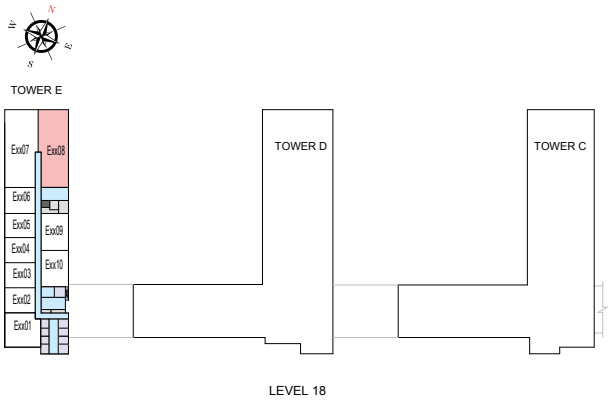

List of unit numbers with this unit plan:

VIEWS

Downtown, Ras Al Khor, Creek, Golf Course, Water body, Amenities
E1808

Downtown, Ras Al Khor, Creek, Golf Course, Water body
E3008, E4208

Disclaimer: 1. All dimensions are in metric, measured to wall finishes. 2. All materials, dimensions & drawings are approximate. 3. Information is subject to change without notice, at developer's absolute discretion. 4. Actual area may vary from the stated area. 5. Drawing are not to scale. 6. All images used are for illustrative purpose only and do not represent the actual size, features, specifications, fittings and furnishings. 7. The developer reserves the right to make revisions/ alterations, at its absolute discretion, without any liability whatsoever.

3 BEDROOM APARTMENT
TYPE E (with maid room + yard)

TOTAL SALEABLE AREA
SUITE = 1,642.57 SQ.FT.
YARD = 539.70 SQ.FT.
TOTAL = 2,182.27 SQ.FT.

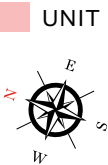
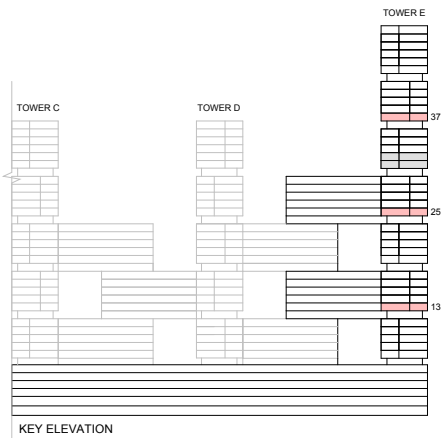

List of unit numbers with this unit plan:

VIEWS

Downtown, Ras Al Khor, Creek, Golf Course, Water body, Amenities
E1308

Downtown, Ras Al Khor, Creek, Golf Course, Water body
E2508, E3708

Disclaimer: 1. All dimensions are in metric, measured to wall finishes. 2. All materials, dimensions & drawings are approximate. 3. Information is subject to change without notice, at developer's absolute discretion. 4. Actual area may vary from the stated area. 5. Drawing are not to scale. 6. All images used are for illustrative purpose only and do not represent the actual size, features, specifications, fittings and furnishings. 7. The developer reserves the right to make revisions/ alterations, at its absolute discretion, without any liability whatsoever.

3 BEDROOM APARTMENT

TYPE E (with maid room + yard)

TOTAL SALEABLE AREA

SUITE = 1,642.57 SQ.FT.

YARD = 539.70 SQ.FT.

TOTAL = 2,182.27 SQ.FT.

UNIT

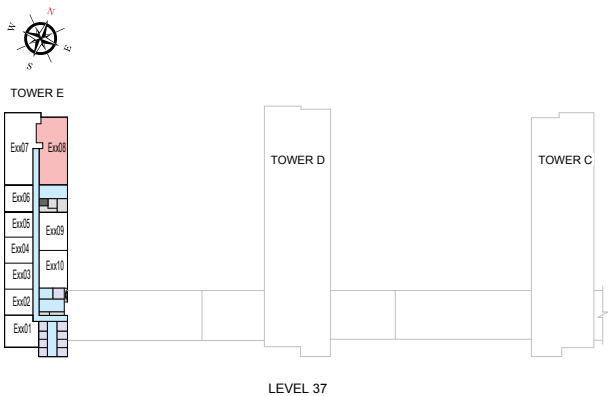
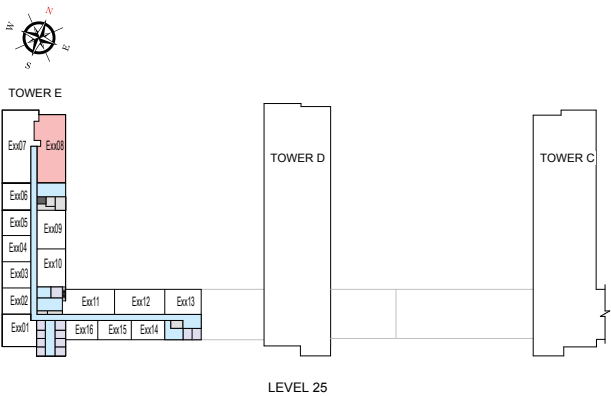
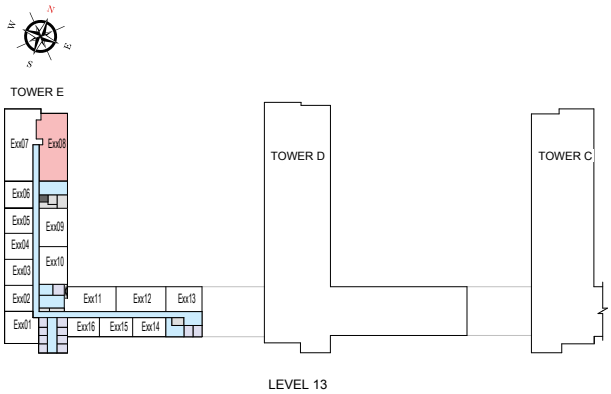

List of unit numbers with this unit plan:

VIEWS

Downtown, Ras Al Khor, Creek, Golf Course, Water body, Amenities
E1308

Downtown, Ras Al Khor, Creek, Golf Course, Water body
E2508, E3708

Disclaimer: 1. All dimensions are in metric, measured to wall finishes. 2. All materials, dimensions & drawings are approximate. 3. Information is subject to change without notice, at developer's absolute discretion. 4. Actual area may vary from the stated area. 5. Drawing are not to scale. 6. All images used are for illustrative purpose only and do not represent the actual size, features, specifications, fittings and furnishings. 7. The developer reserves the right to make revisions/ alterations, at its absolute discretion, without any liability whatsoever.

3 BEDROOM APARTMENT
TYPE E (with maid room + yard) VARIANT 1

TOTAL SALEABLE AREA
SUITE = 1,642.57 SQ.FT.
YARD = 539.70 SQ.FT.
TOTAL = 2,182.27 SQ.FT.

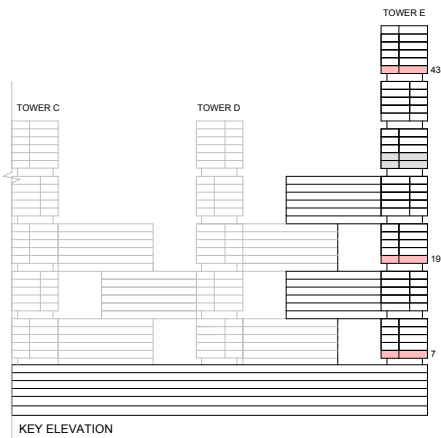

List of unit numbers with this unit plan:

VIEWS

Downtown, Ras Al Khor, Creek, Golf Course, Water body
E707, E1907, E4307

Disclaimer: 1. All dimensions are in metric, measured to wall finishes. 2. All materials, dimensions & drawings are approximate. 3. Information is subject to change without notice, at developer's absolute discretion. 4. Actual area may vary from the stated area. 5. Drawing are not to scale. 6. All images used are for illustrative purpose only and do not represent the actual size, features, specifications, fittings and furnishings. 7. The developer reserves the right to make revisions/ alterations, at its absolute discretion, without any liability whatsoever.

3 BEDROOM APARTMENT
TYPE E (with maid room + yard) VARIANT 1

TOTAL SALEABLE AREA
SUITE = 1,642.57 SQ.FT.
YARD = 539.70 SQ.FT.
TOTAL = 2,182.27 SQ.FT.

UNIT

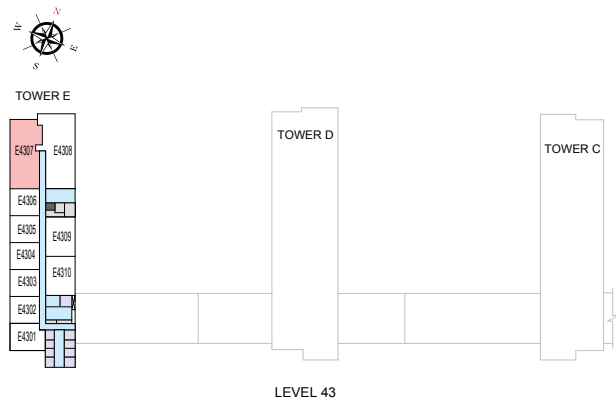
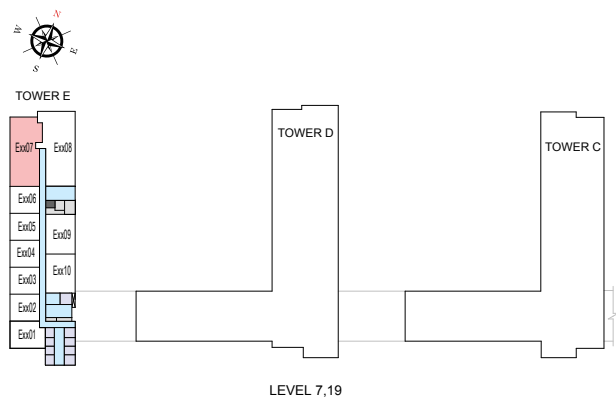

List of unit numbers with this unit plan:

VIEWS

Downtown, Ras Al Khor, Creek, Golf Course, Water body
E707, E1907, E4307

Disclaimer: 1. All dimensions are in metric, measured to wall finishes. 2. All materials, dimensions & drawings are approximate. 3. Information is subject to change without notice, at developer's absolute discretion. 4. Actual area may vary from the stated area. 5. Drawing are not to scale. 6. All images used are for illustrative purpose only and do not represent the actual size, features, specifications, fittings and furnishings. 7. The developer reserves the right to make revisions/ alterations, at its absolute discretion, without any liability whatsoever.

4 BEDROOM APARTMENT

TYPE B (with maid room, store room, powder room + yard)

TOTAL SALEABLE AREA

SUITE = 2,084.43 SQ.FT.

YARD = 477.92 SQ.FT.

TOTAL = 2,562.35 SQ.FT.

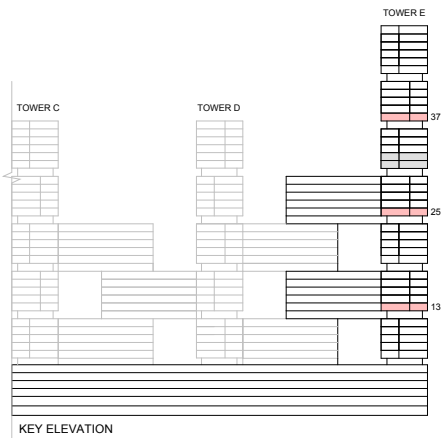

List of unit numbers with this unit plan:

VIEWS

Downtown, Ras Al Khor, Creek, Golf Course, Water body
E1307, E2507, E3707

Disclaimer: 1. All dimensions are in metric, measured to wall finishes. 2. All materials, dimensions & drawings are approximate. 3. Information is subject to change without notice, at developer's absolute discretion. 4. Actual area may vary from the stated area. 5. Drawing are not to scale. 6. All images used are for illustrative purpose only and do not represent the actual size, features, specifications, fittings and furnishings. 7. The developer reserves the right to make revisions/ alterations, at its absolute discretion, without any liability whatsoever.

4 BEDROOM APARTMENT

TYPE B (with maid room, store room, powder room + yard)

TOTAL SALEABLE AREA

SUITE = 2,084.43 SQ.FT.

YARD = 477.92 SQ.FT.

TOTAL = 2,562.35 SQ.FT.

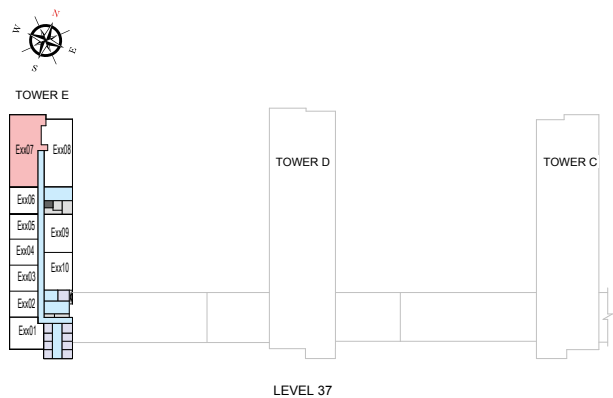
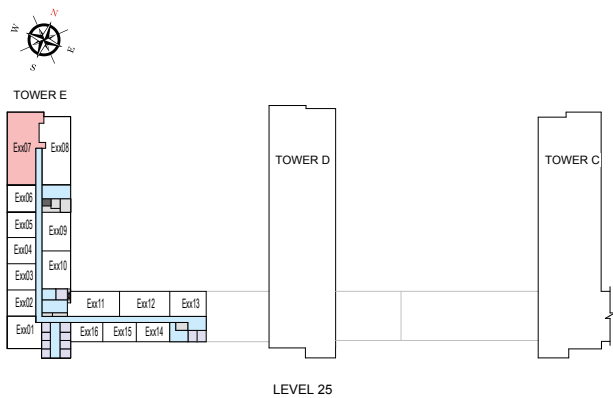
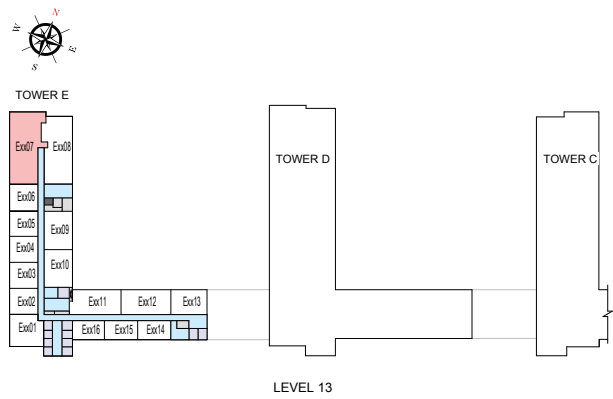

List of unit numbers with this unit plan:

VIEWS

Downtown, Ras Al Khor, Creek, Golf Course, Water body
E1307, E2507, E3707

Disclaimer: 1. All dimensions are in metric, measured to wall finishes. 2. All materials, dimensions & drawings are approximate. 3. Information is subject to change without notice, at developer's absolute discretion. 4. Actual area may vary from the stated area. 5. Drawing are not to scale. 6. All images used are for illustrative purpose only and do not represent the actual size, features, specifications, fittings and furnishings. 7. The developer reserves the right to make revisions/ alterations, at its absolute discretion, without any liability whatsoever.

4 BEDROOM APARTMENT

TYPE B (with maid room, store room, powder room + yard) VARIANT 1

TOTAL SALEABLE AREA

SUITE = 2,084.43 SQ.FT.

YARD = 477.92 SQ.FT.

TOTAL = 2,562.35 SQ.FT.

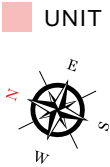
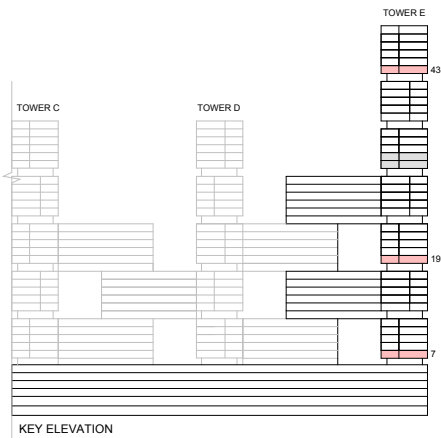

List of unit numbers with this unit plan:

VIEWS

Downtown, Ras Al Khor, Creek, Golf Course, Water body, Amenities
E708, E1908

Downtown, Ras Al Khor, Creek, Golf Course, Water body
E4308

Disclaimer: 1. All dimensions are in metric, measured to wall finishes. 2. All materials, dimensions & drawings are approximate. 3. Information is subject to change without notice, at developer's absolute discretion. 4. Actual area may vary from the stated area. 5. Drawing are not to scale. 6. All images used are for illustrative purpose only and do not represent the actual size, features, specifications, fittings and furnishings. 7. The developer reserves the right to make revisions/ alterations, at its absolute discretion, without any liability whatsoever.

4 BEDROOM APARTMENT

TYPE B (with maid room, store room, powder room + yard) VARIANT 1

TOTAL SALEABLE AREA

SUITE = 2,084.43 SQ.FT.

YARD = 477.92 SQ.FT.

TOTAL = 2,562.35 SQ.FT.

UNIT

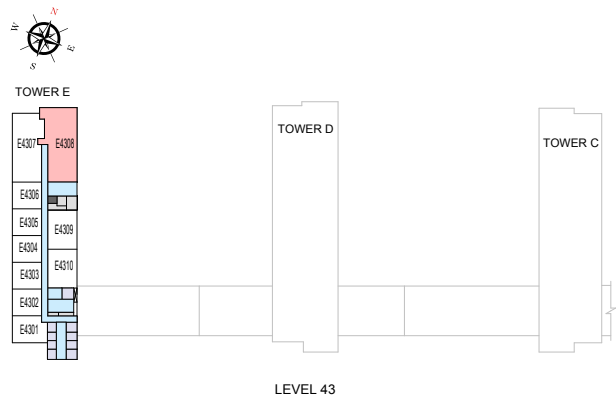
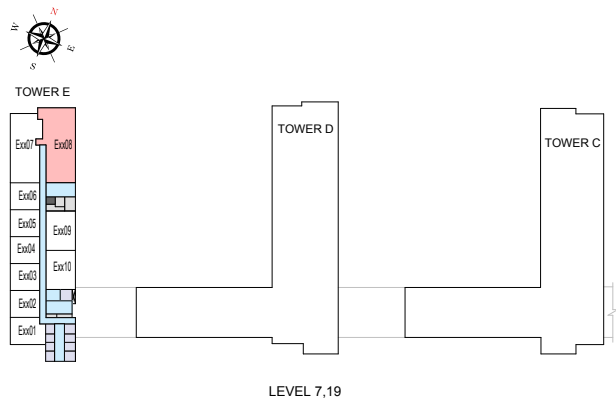

List of unit numbers with this unit plan:

VIEWS

Downtown, Ras Al Khor, Creek, Golf Course, Water body, Amenities
E708, E1908

Downtown, Ras Al Khor, Creek, Golf Course, Water body
E4308

Disclaimer: 1. All dimensions are in metric, measured to wall finishes. 2. All materials, dimensions & drawings are approximate. 3. Information is subject to change without notice, at developer's absolute discretion. 4. Actual area may vary from the stated area. 5. Drawing are not to scale. 6. All images used are for illustrative purpose only and do not represent the actual size, features, specifications, fittings and furnishings. 7. The developer reserves the right to make revisions/ alterations, at its absolute discretion, without any liability whatsoever.