



# THE RESIDENCES









# APARTMENTS



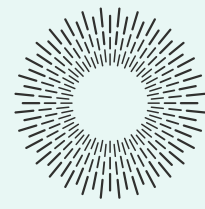

JACOB&CO  
BEACHFRONT LIVING  
*by* OHANA

THE RESIDENCES

# Studio

---

Area Options      50 TO 75 SQM  
538 TO 807 SQFT



This layout does not constitute a cadastral plan and has no contractual validity. The measurements, type, and arrangement of furnishings are purely indicative and representative of the spaces, subject to subsequent changes/variations pursuant to law and contract.



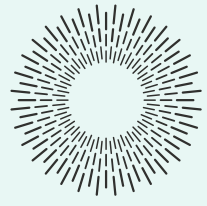

JACOB&CO  
BEACHFRONT LIVING  
*by* OHANA

THE RESIDENCES

# 1 Bedroom

Area Options      88 TO 121 SQM  
947 TO 1,302 SQFT



This layout does not constitute a cadastral plan and has no contractual validity. The measurements, type, and arrangement of furnishings are purely indicative and representative of the spaces, subject to subsequent changes/variations pursuant to law and contract.



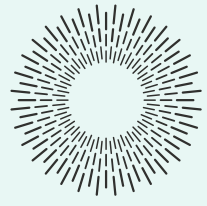

JACOB&CO  
BEACHFRONT LIVING  
*by* OHANA

THE RESIDENCES

# 2 Bedroom

Area Options      127.5 TO 178 SQM  
1,372 TO 1,916 SQFT



This layout does not constitute a cadastral plan and has no contractual validity. The measurements, type, and arrangement of furnishings are purely indicative and representative of the spaces, subject to subsequent changes/variations pursuant to law and contract.



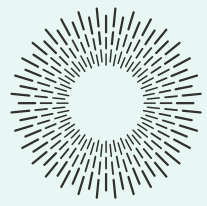

JACOB&CO  
BEACHFRONT LIVING  
*by* OHANA

THE RESIDENCES

# 3 Bedroom

Area Options      203 TO 246 SQM  
2,185 TO 2,648 SQFT



This layout does not constitute a cadastral plan and has no contractual validity. The measurements, type, and arrangement of furnishings are purely indicative and representative of the spaces, subject to subsequent changes/variations pursuant to law and contract.





PENTHOUSES









# Penthouse

Internal Area	353 sqm
Terrace	233 sqm
<b>Total Area</b>	<b>586 SQM</b>
	<b>6,308 SQFT</b>

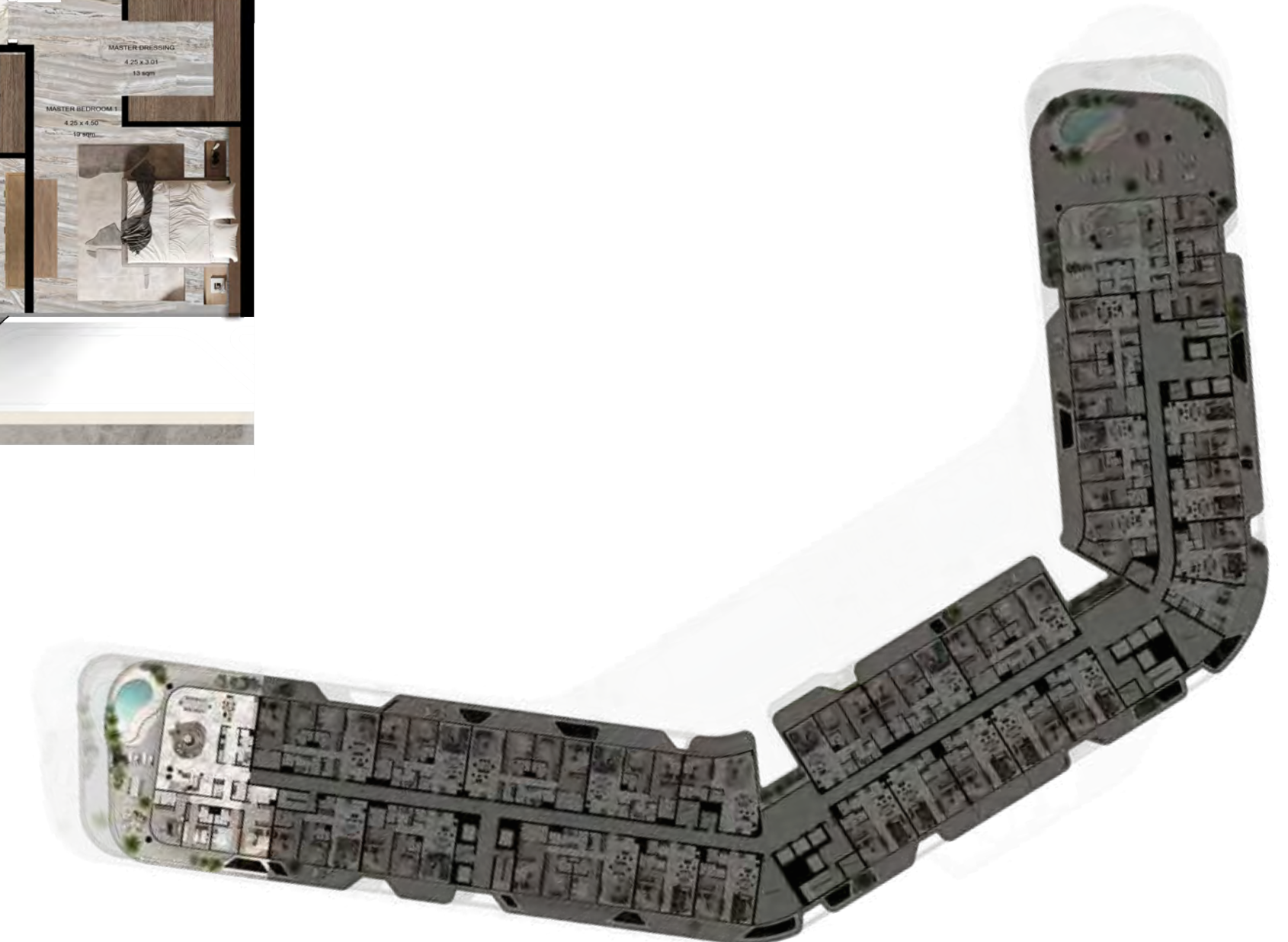
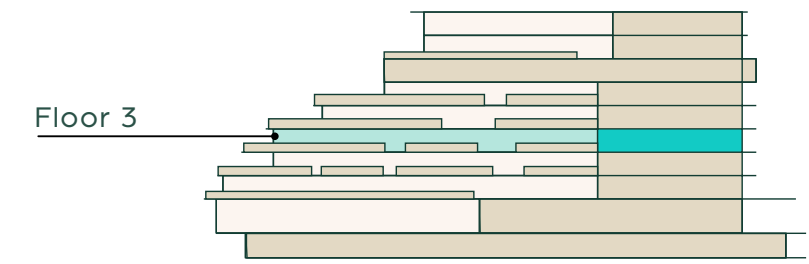



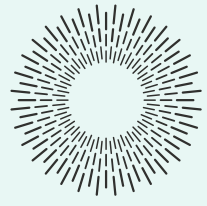

JACOB&CO  
BEACHFRONT LIVING  
*by* OHANA

THE RESIDENCES

Penthouse

TYPE B - FOURTH FLOOR

Internal Area                      354 sqm

Terrace                                595 sqm

Total Area                            **949 SQM**  
**10,215 SQFT**

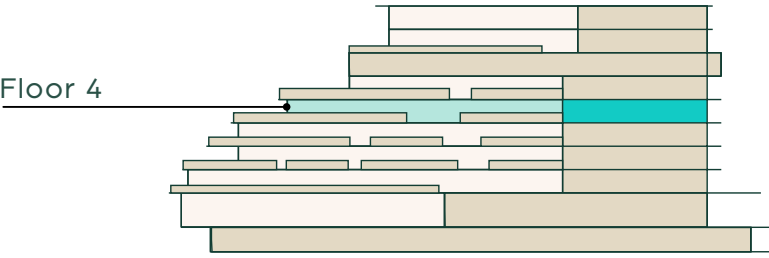

This layout does not constitute a cadastral plan and has no contractual validity. The measurements, type, and arrangement of furnishings are purely indicative and representative of the spaces, subject to subsequent changes/variations pursuant to law and contract.





# SKY MANSIONS











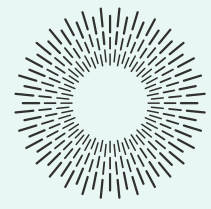

JACOB&CO  
BEACHFRONT LIVING  
*by* OHANA

THE RESIDENCES

# Sky Mansion

Area Options 1,721 TO 2,209 SQM  
18,525 TO 23,777 SQFT



GROUND FLOOR



FIRST FLOOR

This layout does not constitute a cadastral plan and has no contractual validity. The measurements, type, and arrangement of furnishings are purely indicative and representative of the spaces, subject to subsequent changes/variations pursuant to law and contract.



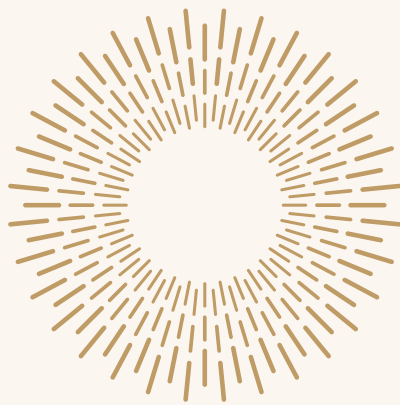

JACOB&CO  
BEACHFRONT LIVING  
*by* OHANA



The information, images, and illustrations contained in this presentation are for illustrative and representational purposes only. While OHANA REAL ESTATE DEVELOPMENT AND CONSTRUCTION LLC (“Ohana”) strives to provide accurate and up-to-date information, all layouts, floor plans, areas, dimensions, designs, and specifications mentioned herein are subject to change in accordance with applicable laws, regulations, and Ohana’s policies without prior notice. Nothing in this brochure constitutes or shall be construed as a legal offer, invitation to treat, or any form of legally binding obligation or agreement. The images and artistic renderings included are intended to convey the general concept and vision of the project and may not represent the actual product or finishes. Prospective buyers are advised to refer to the final terms of any sale agreement for specific details and to seek independent legal advice as necessary. Ohana reserves the right to make modifications, amendments, or substitutions in line with the development process or legal requirements. All materials, images, and illustrations included in this presentation are and shall remain the exclusive property of Ohana or its licensors, as the case may be. Nothing in this presentation grants or shall be construed as granting any person or entity any rights, including intellectual property rights, in such materials, images, or illustrations.

JACOB&CO

The involvement of Jacob in this Project is limited to the concepts for the interior/architectural design of the Project and to the supply of certain Jacob products provided by OHANA to the purchasers of the Residential Units. In no circumstances is the owner of the Residential Unit authorised to use any Jacob Trademarks but shall have the right to refer to himself as the owner of a Residential Unit that is Jacob & Co. branded and post pictures and videos relating thereto.



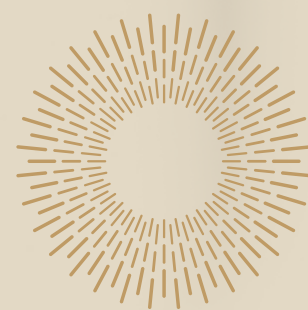

JACOB&CO  
BEACHFRONT LIVING

*by* OHANA

Phone Number  
+97154 222 8281

Email Address  
info@ohana.ae

Website  
ohana.ae