



WADI

VILLAS

BY ARISTA PROPERTIES
DISTRICT 11 MEYDAN



ARISTA
PROPERTIES



Project Design:
HBA Architects is
renowned for creating
innovative and enduring
design solutions that
respect and embody
community heritage.

 **HBA**architecture

A diverse team of over 30 skilled architects, designers, and planners brings a wealth of expertise and local knowledge to each project. Selected for their ability to create inspirational architecture for landmark projects globally, HBA Architects specialises in meeting the unique needs of discerning clients in luxury markets, delivering designs that are exceptional and sustainably integrated into their surroundings.



Arrazuna at The Link, One Za'abeel, Dubai



Sphere at The Link, One Za'abeel, Dubai



Taj Exotica Resort & Spa, Dubai



Qasr Al Sarab by Anantara, Abu Dhabi

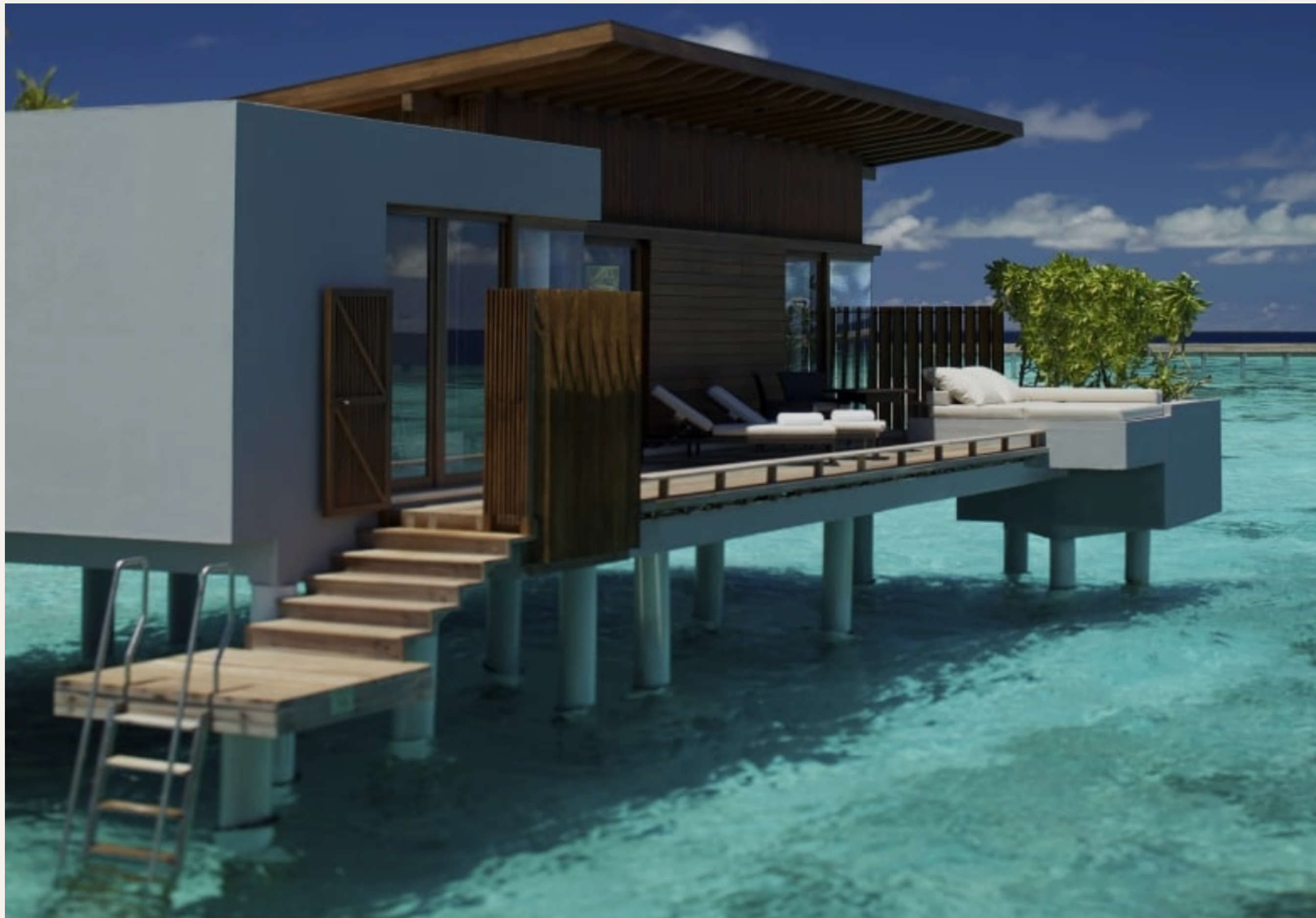

Park Hyatt, Maldives

Landscape Design:
Artfully crafted by
Coopers Hill who
expertly help connect
people to nature and
nature to people.



COOPERS HILL

Coopers Hill, with over 40 years of experience in landscape design worldwide, is renowned for their culturally sensitive and responsible approach to harmonising the natural environment with human spaces. Their expertise lies in creating unique, award-winning designs with a focus on sustainable, timeless, and high-quality design that transcends fads and fashions, aligning the needs of mankind with the preservation of the natural world.





PAGANI RESIDENCES, DUBAI

The essence of Pagani Residences' landscape design is to create a captivating experience—a moment to pause and enjoy unobstructed views of Dubai's iconic skyline.

The pool deck area, offering fantastic views of the Burj Khalifa, is envisioned as an oasis where tranquility meets luxury. We celebrate Pagani's brand values by drawing inspiration from its metallic details and geometric elegance for the curation and design of the hardscape and feature planters in the landscape. The design prioritises privacy and comfort for guests with a functional layout and thoughtfully curated accent planting suitable for the Dubai climate.

The landscape design for Pagani Residences elegantly embodies modernity and simplicity, harmoniously blending opulent luxury with a connection to nature.



CONRAD, BALI

The 350-room Conrad Bali was constructed on a flat land fill area with minimal existing vegetation or landscape character.

The vision for the landscape design of this sophisticated family beach resort was to capture the spirit of Bali, drawing inspiration from various sources. To give guests a strong sense of place and to capture Bali's unique character, the landscaped terraces incorporated elements of water, fire, stone and planting, together with Balinese construction techniques materials and artwork.



INTERCONTINENTAL PHUKET RESORT

A unique combination of classical Thai mythology, nature and resort luxury with high-end hospitality facilities for tourists and business travelers alike. With conventions & exhibitions gaining momentum to reach pre-pandemic status globally, we're happy to share that this project won the 2021-2023 - Thailand MICE Venue Standard (TMVS) award.

The range of bespoke landscape details for this project were extensive. Balancing Thai cultural referencing, symbolism and tradition with a contemporary and clean-lined aesthetic required unique solutions, details, materials, artwork design and plant species selection.

WADI

VILLAS

BY ARISTA PROPERTIES
DISTRICT 11 MEYDAN