



# KNIGHTSBRIDGE

MEYDAN DISTRICT 11

DUBAI'S FIRST CLIMATE-ADAPTIVE WELLNESS COMMUNITY

FLOOR PLANS





LEOS

4 BEDROOM  
TOWNHOUSES



# 4 Bedroom TOWNHOUSES

-  TOWNHOUSE A1  
27 units
-  TOWNHOUSE A2/A3  
16 units



## TOWNHOUSE FEATURES



Fresh harvest  
garden



Smart home  
system



Private  
temperature  
controlled pool



Spacious  
private elevator



Karesansui  
Balcony garden



Open  
kitchen



Walk-in Closet



Climate controlled  
outdoor shaded  
terrace



Maid's room &  
bathroom



Smart irrigation  
system



AI security  
automation

## DETAILS

**Number of Bedrooms:**

4

**Total Number of Units:**

43

**Estimated NSA:**

3,937 - 3,971 sq.ft

**Plot Area Ranges:**

1,853 - 4,191 sq.ft



4 Bedroom  
TOWNHOUSE



Ground Floor



First Floor



Second Floor



4 Bedroom  
*TOWNHOUSE*



Ground Floor



First Floor



Second Floor





4 Bedroom  
TOWNHOUSE



Ground Floor



First Floor



Second Floor



5 BEDROOM  
VILLAS



5 Bedroom  
VILLA

5 BEDROOM VILLA  
18 units



## 5 BEDROOM VILLA FEATURES



Double height  
grand entrance



Fresh harvest  
garden



Smart home  
system



Private  
temperature  
controlled pool



Takibi  
Firepit



Spacious  
private elevator



Blockbuster  
private cinema



Chef kitchen



Open  
kitchen



Walk-in Closet



Private  
Jacuzzi



Climate controlled  
outdoor shaded  
terrace



Karesansui  
Balcony garden



Maid's & driver's  
room & bathroom



Smart irrigation  
system



AI security  
automation

## DETAILS

Number of Bedrooms:

5

Total Number of Units:

18

Estimated NSA:

5,657 sq.ft

Plot Area Ranges:

4,478 - 7,722 sq.ft



# 5 Bedroom VILLA



Ground Floor



First Floor



Second Floor



6 BEDROOM  
SIGNATURE VILLAS



6 Bedroom  
*SIGNATURE VILLAS*

 SIGNATURE VILLAS  
5 units



## 6 BEDROOM SIGNAUTRE VILLA FEATURES



Triple height  
grand entrance



Fresh harvest  
garden



Dedicated  
wellness area



Private  
temperature  
controlled pool



Takibi  
Firepit



Spacious  
private elevator



Blockbuster  
private cinema



Chef kitchen



Open  
kitchen



Walk-in Closet



Private  
Jacuzzi



Climate controlled  
outdoor shaded  
terrace



Karesansui  
Balcony garden



Maid's & driver's  
room & bathroom



Smart home  
system



Smart irrigation  
system



AI security  
automation

## DETAILS

Number of Bedrooms:

6

Total Number of Units:

5

Estimated NSA:

7,260 sq.ft

Plot Area Ranges:

7,131 - 8,717 sq.ft



# 6 Bedroom *SIGNATURE VILLAS*



Ground Floor

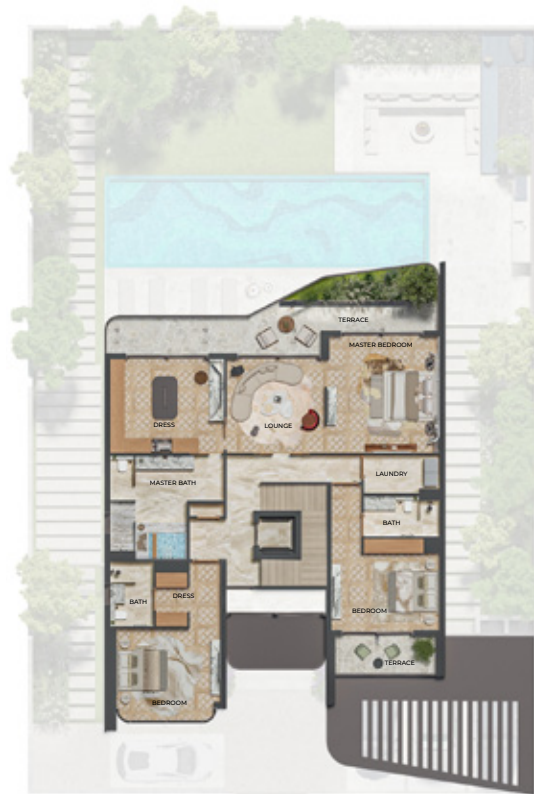

First Floor



Second Floor



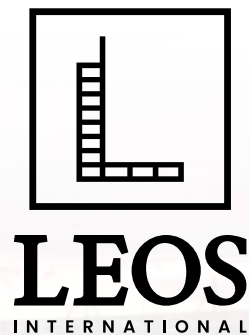

OFFICIAL PARTNER OF  
**AFC BOURNEMOUTH**  
PREMIER LEAGUE



